

CITY OF TULSA  
YALE AVE. WIDENING – 81<sup>ST</sup> TO 91<sup>ST</sup>  
IMPROVE OUR TULSA  
PROJECT 144101

PRE-CONSTRUCTION PUBLIC MEETING

SEPT. 28<sup>TH</sup>, 2021



CITY OF  
**Tulsa**  
*A New Kind of Energy.*



YALE AVE. WIDENING – 81<sup>ST</sup> TO 91<sup>ST</sup>  
PRE-CONSTRUCTION PUBLIC MEETING  
- IMPROVE OUR TULSA PROJECT 144101 -

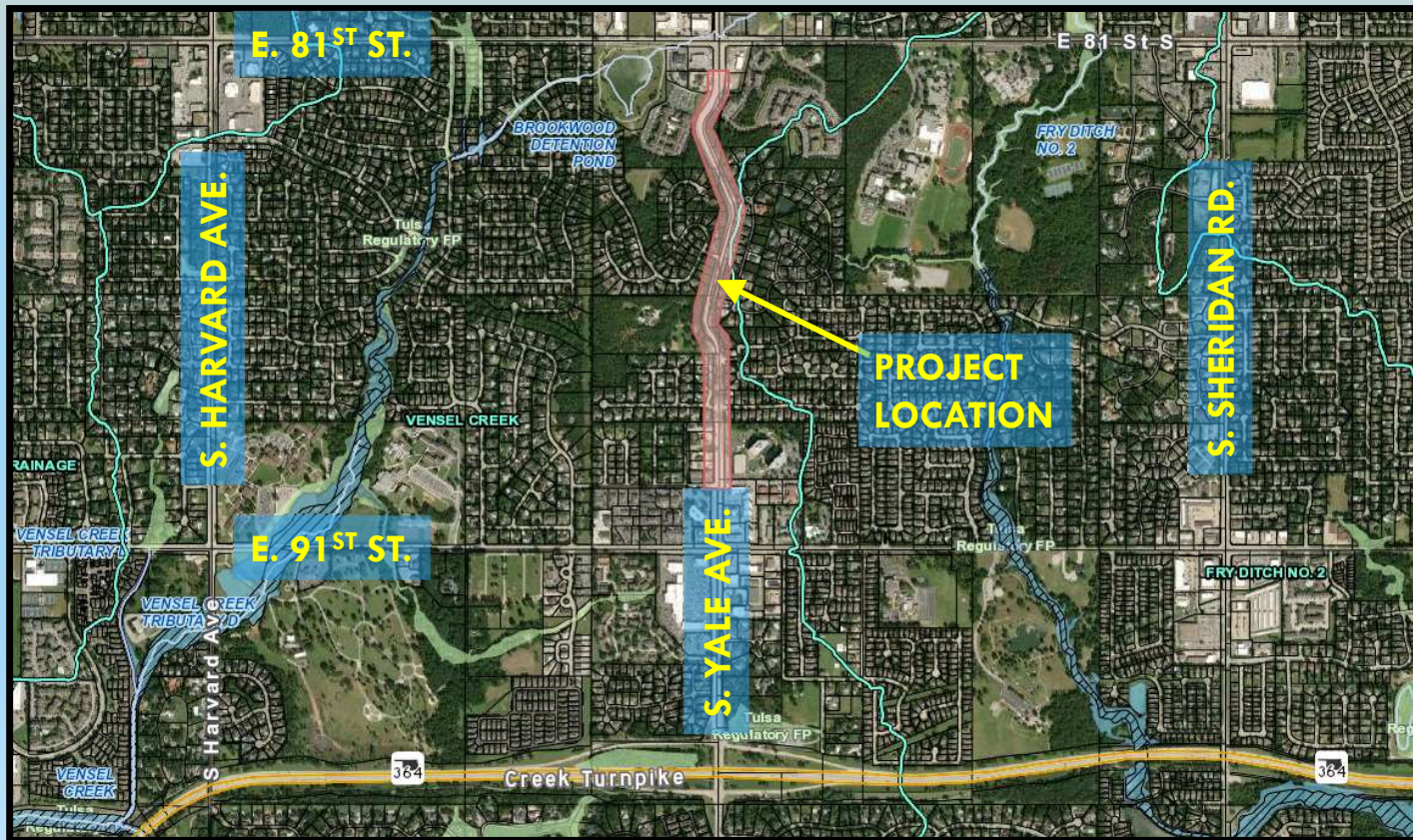

# YALE AVE. WIDENING – 81<sup>ST</sup> TO 91<sup>ST</sup> PRE-CONSTRUCTION PUBLIC MEETING - OVERVIEW -

- INTRODUCTIONS
- DISTRICT 8 COUNCILOR REMARKS
- OVERVIEW OF PROJECT ELEMENTS
- CONSTRUCTION PHASING
- QUESTION & ANSWER SESSION
- *NOTE: MEETING WILL BE RECORDED IN ORDER TO ENSURE ALL QUESTIONS & COMMENTS ARE ACCURATELY CAPTURED FOR REVIEW AND RESPONSE.*

# YALE AVE. WIDENING – 81<sup>ST</sup> TO 91<sup>ST</sup>

## PROJECT TEAM

- **DESIGN TEAM:**

- CITY OF TULSA - TRANSPORTATION DESIGN
  - DESIGN LEAD ENGINEER: DOUG HELT, P.E., S.E.
  - DESIGN PROJECT MANAGER: PATTY PARKS, E.I.
- DESIGN CONSULTANT: BENHAM ENGINEERS
  - JARED PODOLNY, P.E.
  - KAREN JONES, P.E.



# YALE AVE. WIDENING – 81<sup>ST</sup> TO 91<sup>ST</sup>

## PROJECT TEAM

- **CONSTRUCTION TEAM:**

- CITY OF TULSA - FIELD ENGINEERING
  - CONSTRUCTION MANAGER: ELLIOTT STILES, P.E., CFM
  - CONSTRUCTION INSPECTION MANAGER: JEREMY STAHLE, P.E. (CEC)
  - CONSTRUCTION INSPECTOR: STEVE MEDINA (HNTB)
- PRIME CONTRACTOR: BECCO CONTRACTORS
  - PROJECT MANAGER: RYAN FRANSISCO
  - SUPERINTENDENT (GENERAL): ALVIN ATKINSON
  - SUPERINTENDENT (RETAINING WALLS): MIKE TOWNSON





# YALE AVE. WIDENING – 81<sup>ST</sup> TO 91<sup>ST</sup>

## DISTRICT 8 COUNCILOR REMARKS

- **DISTRICT 8 COUNCILOR: PHIL LAKIN**

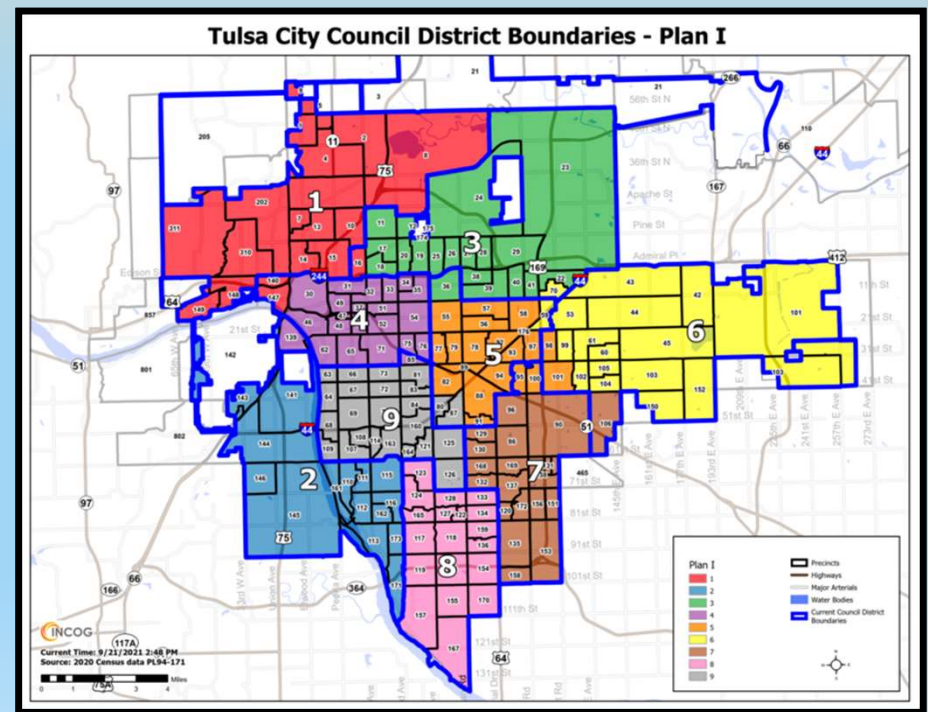

# YALE AVE. WIDENING – 81<sup>ST</sup> TO 91<sup>ST</sup>

## QUESTION & ANSWER

- **QUESTIONS & COMMENTS:**

- DURING PRESENTATION, FEEL FREE TO ADD QUESTIONS & COMMENTS TO THE CHAT. THESE WILL BE ADDRESSED, ONE-AT-A-TIME, AT THE END OF THE PRESENTATION.
- **FORMAT:** [NAME]: QUESTION/COMMENT

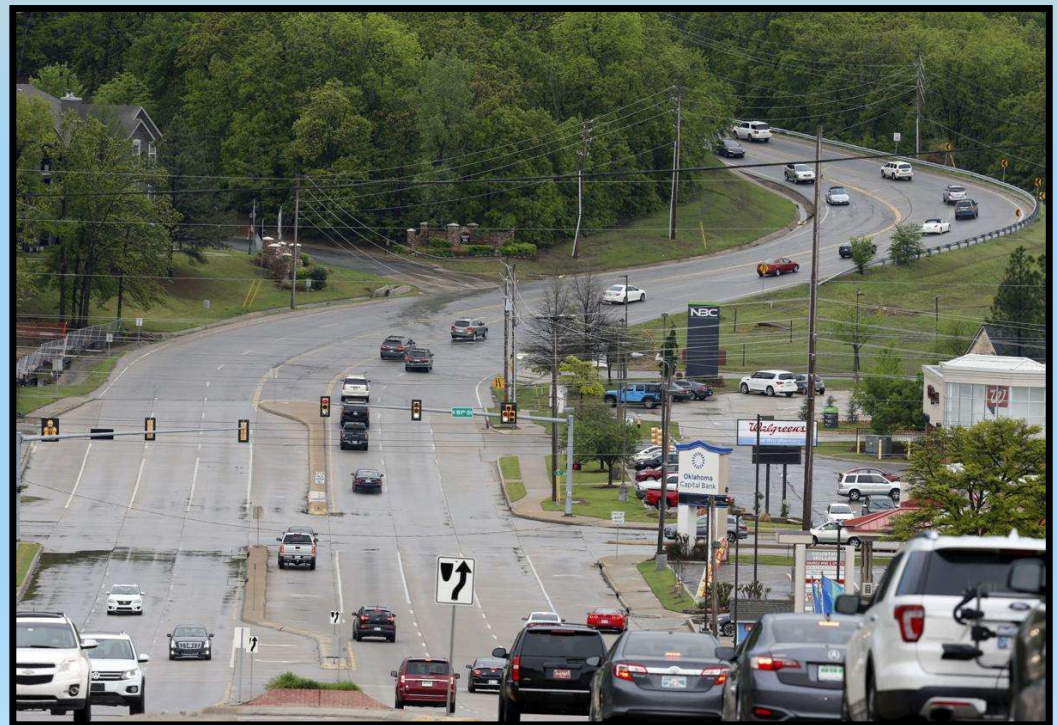

# YALE AVE. WIDENING – 81<sup>ST</sup> TO 91<sup>ST</sup>

## OVERVIEW OF PROJECT ELEMENTS

- **BUDGET:**

- CONTRACT AMOUNT: \$29,257,000.00
- FUNDING SOURCE:
  - IMPROVE OUR TULSA - PACKAGE 1

- **TIMELINE:**

- CONTRACT DURATION: 670 DAYS
- CONTRACT START: OCT 25, 2021
- PROJECTED COMPLETION: AUG 26, 2023

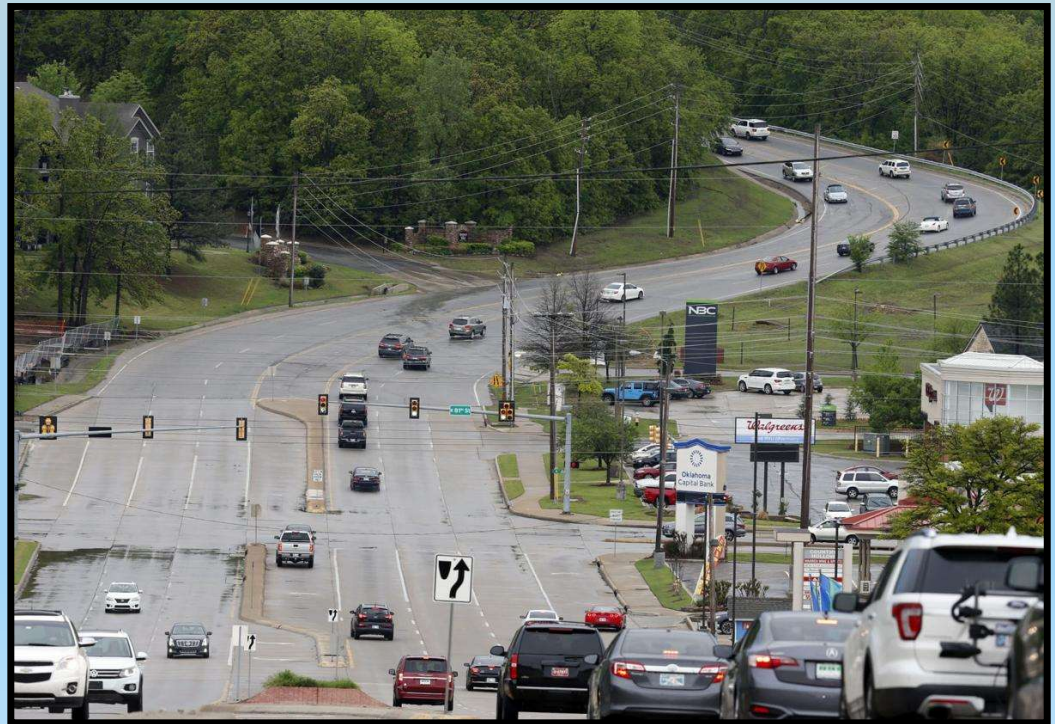



# YALE AVE. WIDENING – 81<sup>ST</sup> TO 91<sup>ST</sup>

## OVERVIEW OF PROJECT ELEMENTS

- **ROADWAY:**

- RECONFIGURATION OF YALE AVE.

- CURRENT LAYOUT:

- 2 DRIVING LANES
      - NO SIDEWALKS
      - STEEP DROP-OFFS
      - TIGHT CURVES

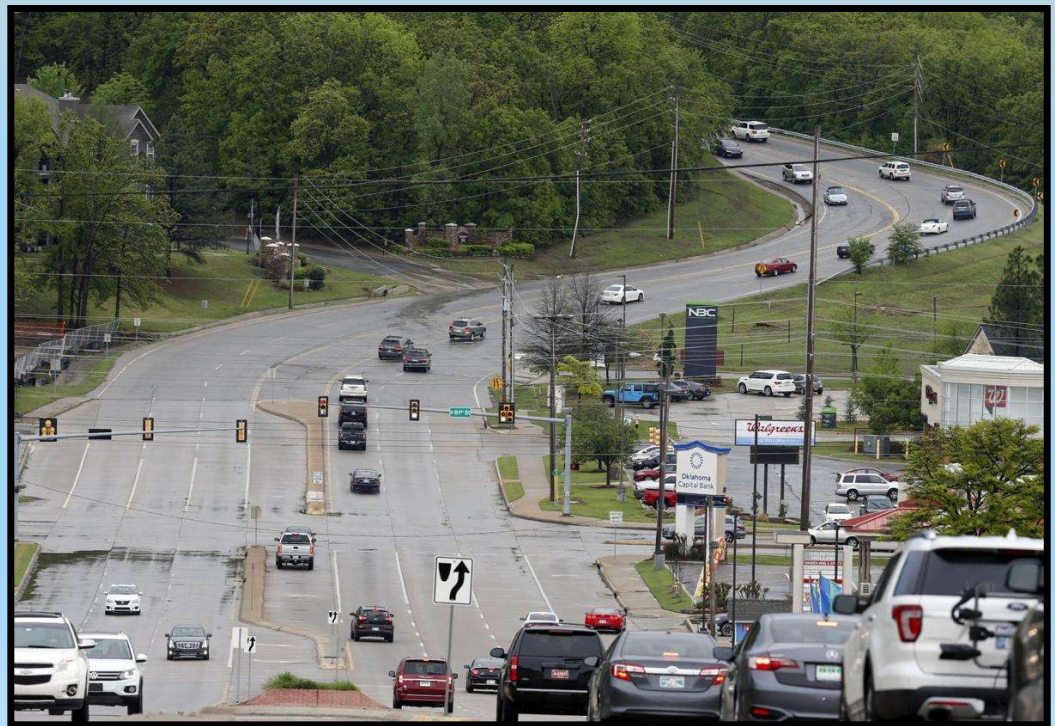

# YALE AVE. WIDENING – 81<sup>ST</sup> TO 91<sup>ST</sup>

## OVERVIEW OF PROJECT ELEMENTS

- **ROADWAY:**

- RECONFIGURATION OF YALE AVE.
  - POST-PROJECT:
    - 6 DRIVING LANES (9”-THICK CONCRETE) – DIVIDED BY RAISED, LANDSCAPED CENTER MEDIAN WITH DEDICATED LEFT TURN BAYS
      - IMPROVED CAPACITY FOR HIGHER TRAFFIC VOLUMES
      - SAFER TURNING MOVEMENTS
    - SIDEWALKS (6’-WIDE) ON BOTH SIDES OF YALE AVE.
    - SMOOTH GRADING BETWEEN STREET AND RETAINING WALLS WILL ELIMINATE DROP-OFFS
    - TIGHT CURVES – TO BE FLATTENED FOR IMPROVED SIGHT DISTANCE

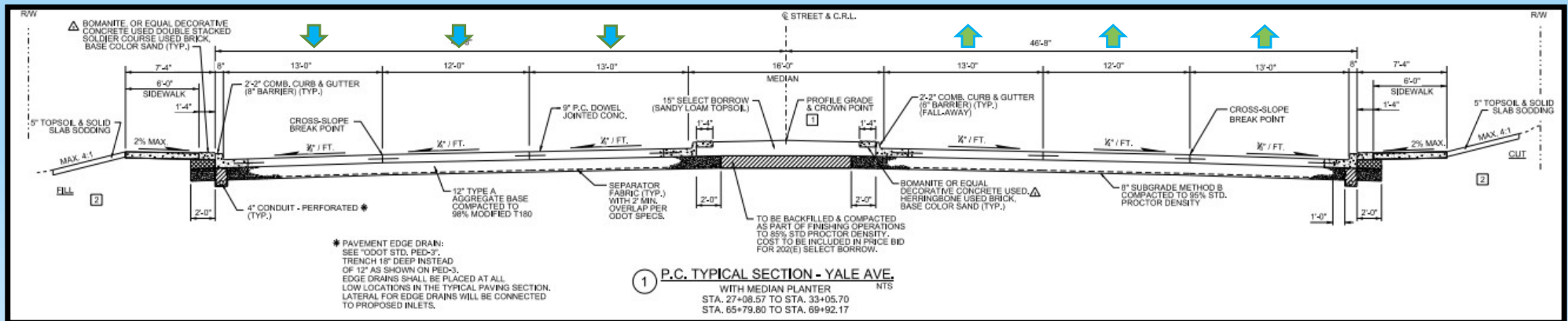

# YALE AVE. WIDENING – 81<sup>ST</sup> TO 91<sup>ST</sup>

## OVERVIEW OF PROJECT ELEMENTS

- **RETAINING WALLS:**

- ELEMENTS:

- PIERS (DRILLED SHAFTS) – DRILLED INTO GROUND AND FILLED WITH REINFORCED CONCRETE
  - DEPTHS RANGE FROM LESS THAN 10' TO MORE THAN 50' DEEP
  - DIAMETER: 30" (SPACED ABOUT 4' TO 6' APART); 60" (SPACED 10' TO 12' APART)
- GRADE BEAMS – REINFORCED CONCRETE BEAM RUNNING FROM PIER-TO-PIER
- RETAINING WALL – REINFORCED CONCRETE WALL, HOLDING SOIL IN PLACE
  - HEIGHTS RANGE FROM LESS THAN 5' TO MORE THAN 25' TALL
- SCREENING WALL – TOP PORTION OF WALL SYSTEM W/ DECORATIVE SURFACE TREATMENT
  - HEIGHTS GENERALLY 8', 9' AND 10'

# YALE AVE. WIDENING – 81<sup>ST</sup> TO 91<sup>ST</sup>

## OVERVIEW OF PROJECT ELEMENTS

- **RETAINING WALLS:**

- FOUR DIFFERENT WALL TYPES:

- TYPE 1: CONVENTIONAL CONCRETE RETAINING WALL W/ SCREENING WALL (NO PIERS)
- TYPE 2: SCREENING WALL ON DRILLED SHAFTS (SMALLEST TYPE)
- TYPE 3: DRILLED SHAFT RETAINING WALL
- TYPE 4: SLOPE STABILIZATION WALL (LARGEST TYPE)



# YALE AVE. WIDENING – 81<sup>ST</sup> TO 91<sup>ST</sup>

## OVERVIEW OF PROJECT ELEMENTS

- RETAINING WALLS:**

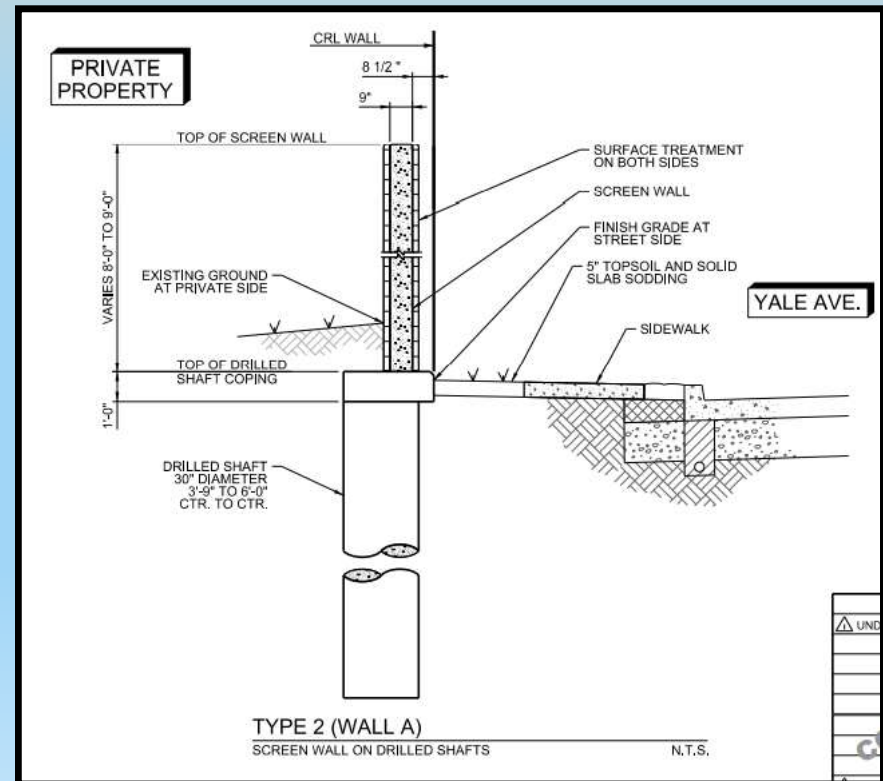
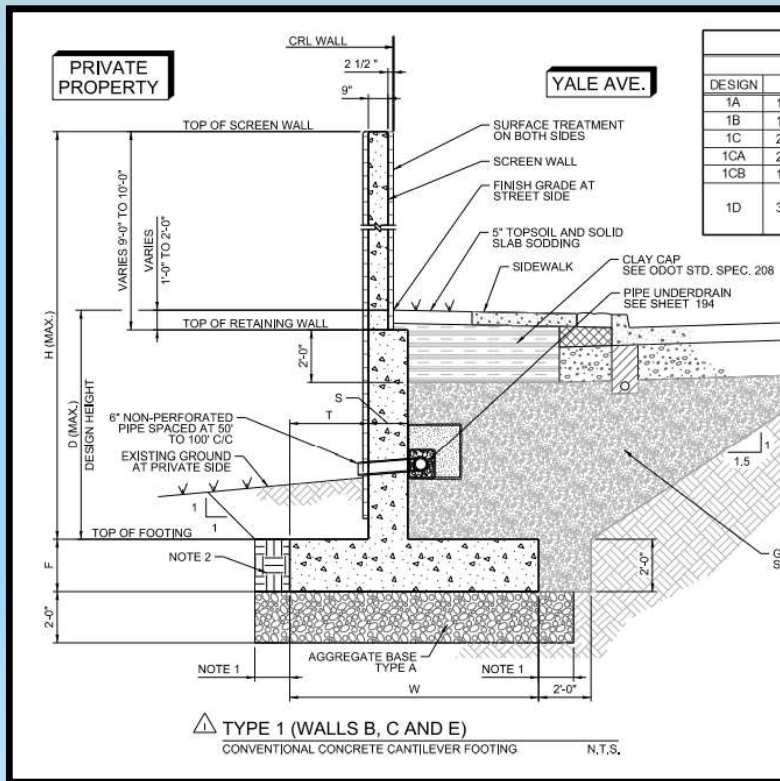

# YALE AVE. WIDENING – 81<sup>ST</sup> TO 91<sup>ST</sup>

## OVERVIEW OF PROJECT ELEMENTS

### • RETAINING WALLS:

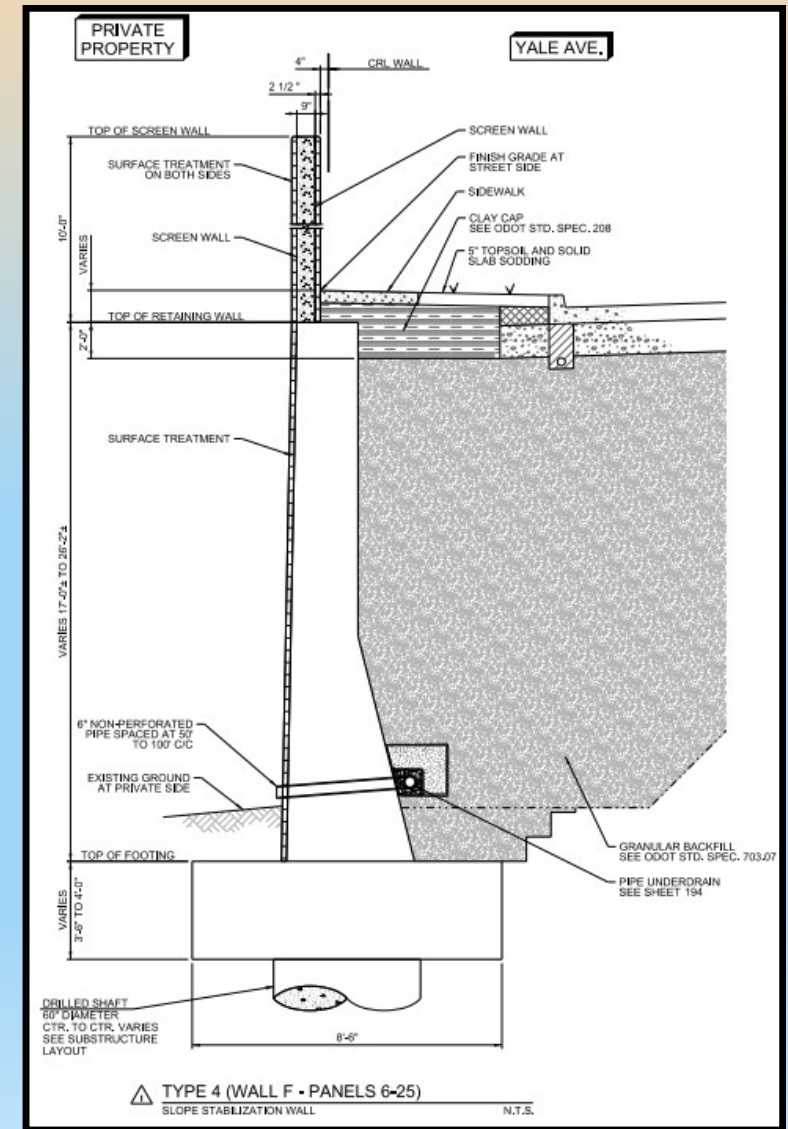
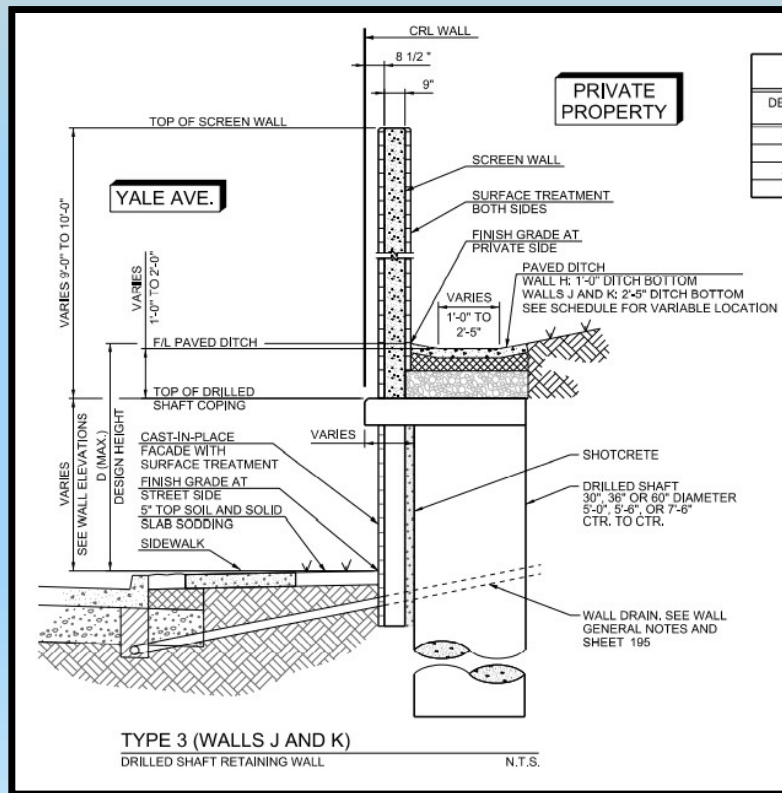

# YALE AVE. WIDENING – 81<sup>ST</sup> TO 91<sup>ST</sup>

## OVERVIEW OF PROJECT ELEMENTS

- **STORMWATER:**

- TWO NEW DRAINAGE MAINS:

- NORTH SLOPE

- FROM 85<sup>TH</sup> TO 81<sup>ST</sup>
      - PIPE SIZES UP TO 36" DIAMETER

- SOUTH SLOPE

- FROM 91<sup>ST</sup> TO 85<sup>TH</sup>
      - PIPE SIZES UP TO 36" DIAMETER

- OVERALL SYSTEM DESIGNED FOR 100-YEAR STORM (1% CHANCE) CAPACITY



# YALE AVE. WIDENING – 81<sup>ST</sup> TO 91<sup>ST</sup>

## OVERVIEW OF PROJECT ELEMENTS

- **WATERLINE:**

- NEW WATERLINE MAIN
  - WILL RUN ALONG EAST SIDE OF YALE AVE.
  - SIZE OF MAIN 12" & 16"
- NEW 8" WATERLINE LATERALS TO NEIGHBORHOOD SYSTEMS





# YALE AVE. WIDENING – 81<sup>ST</sup> TO 91<sup>ST</sup>

## OVERVIEW OF PROJECT ELEMENTS

- **SANITARY SEWER:**

- SMALL AMOUNT OF SEWER TO BE INSTALLED NEAR SIGNAL HILL ENTRANCE (84<sup>TH</sup> ST.) IN ORDER TO ACCOMMODATE A RETAINING WALL.

# YALE AVE. WIDENING – 81<sup>ST</sup> TO 91<sup>ST</sup>

## CONSTRUCTION PHASING

### - OVERVIEW -

- CONSTRUCTION TO BEGIN **OCTOBER 25<sup>TH</sup>, 2021** AND TAKE PLACE IN **FOUR** PHASES.
- EACH PHASE WILL INCLUDE A COMBINATION OF CONSTRUCTION TYPES, INCLUDING:

- ROADWAY (INCLUDES SIDEWALKS, RAISED MEDIANS, LANDSCAPING)
- RETAINING WALLS
- WATERLINE
- STORM SEWER
- SANITARY SEWER



Sunday	Monday	Tuesday	Wednesday	Thursday	Friday	Saturday
					1	2
3	4	5	6	7	8	9
10	11	12	13	14	15	16
17	18	19	20	21	22	23
24	25	26	27	28	29	30
31						

- **IMPORTANT NOTE:** DATES PROVIDED IN THIS PRESENTATION ARE BASED ON THE BASELINE SCHEDULE AND ARE, THUS, SUBJECT TO CHANGE IF UNFORESEEN CONDITIONS ARISE DURING CONSTRUCTION.

# YALE AVE. WIDENING – 81<sup>ST</sup> TO 91<sup>ST</sup>

## CONSTRUCTION PHASING

### - PHASE 1 –

**IMPORTANT NOTE:** DATES PROVIDED IN THIS PRESENTATION ARE BASED ON THE BASELINE SCHEDULE AND ARE, THUS, SUBJECT TO CHANGE IF UNFORESEEN CONDITIONS ARISE DURING CONSTRUCTION.

- **START:** OCT-2021
- **END:** JAN-2022
- **DURATION:** APPROXIMATELY 4 MONTHS
- **TRAFFIC:** NORMAL OPERATIONS – ALL LANES OPEN
- **ROADWAY:** N/A
- **RETAINING WALLS:** 'F' (TYPE 4 – BROOKWOOD II – “*THE BIGGIN*”)
- **WATERLINE:** 'D' (ALONG WALL 'F'); 'K' (TEMP LINE); 'M' (TEMP LINE TO SIGNAL HILL @ 84<sup>TH</sup>)
- **STORM SEWER:** N/A
- **SANITARY SEWER:** N/A

# YALE AVE. WIDENING – 81<sup>ST</sup> TO 91<sup>ST</sup>

## CONSTRUCTION PHASING

- PHASE 1 -

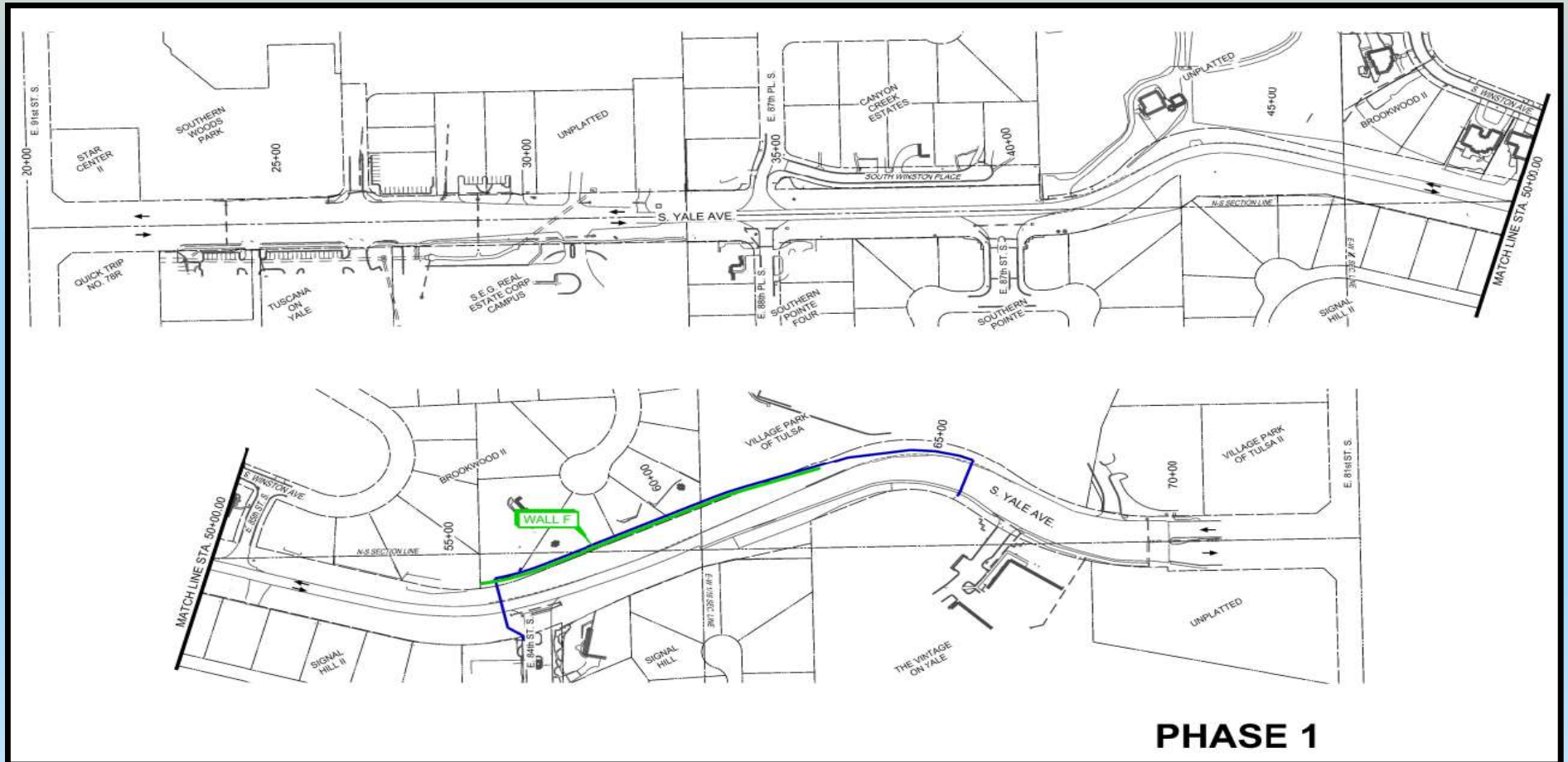



# YALE AVE. WIDENING – 81<sup>ST</sup> TO 91<sup>ST</sup>

## CONSTRUCTION PHASING

### - PHASE 2 –

**IMPORTANT NOTE:** DATES PROVIDED IN THIS PRESENTATION ARE BASED ON THE BASELINE SCHEDULE AND ARE, THUS, SUBJECT TO CHANGE IF UNFORESEEN CONDITIONS ARISE DURING CONSTRUCTION.

- **START:** JAN-2022
- **END:** MAY-2022
- **DURATION:** APPROXIMATELY 4 MONTHS
- **TRAFFIC:** FULL CLOSURE TO THRU TRAFFIC – ALL LANES CLOSED – LOCAL TRAFFIC MAY PASS
- **ROADWAY:** SOUTHBOUND PERMANENT AND TEMP PAVEMENT (CANYON CREEK; BROOKWOOD)
- **RETAINING WALLS:** 'A' (SOUTH OF 87<sup>TH</sup> PL.); 'B' (CANYON CREEK); 'C' (CATE PROPERTY – SOUTH ¼); 'E'/'F' (BROOKWOOD); 'M' (CATE PROPERTY)
- **WATERLINE:** 'B' (ALONG WALL 'A'); 'F' (88<sup>TH</sup> PL. TO SOUTHERN POINTE)
- **STORM SEWER:** SOUTH SLOPE MAIN (89<sup>TH</sup> TO 87<sup>TH</sup>); NORTH SLOPE MAIN (84<sup>TH</sup>)
- **SANITARY SEWER:** N/A

# YALE AVE. WIDENING – 81<sup>ST</sup> TO 91<sup>ST</sup>

## CONSTRUCTION PHASING

### - PHASE 2 -

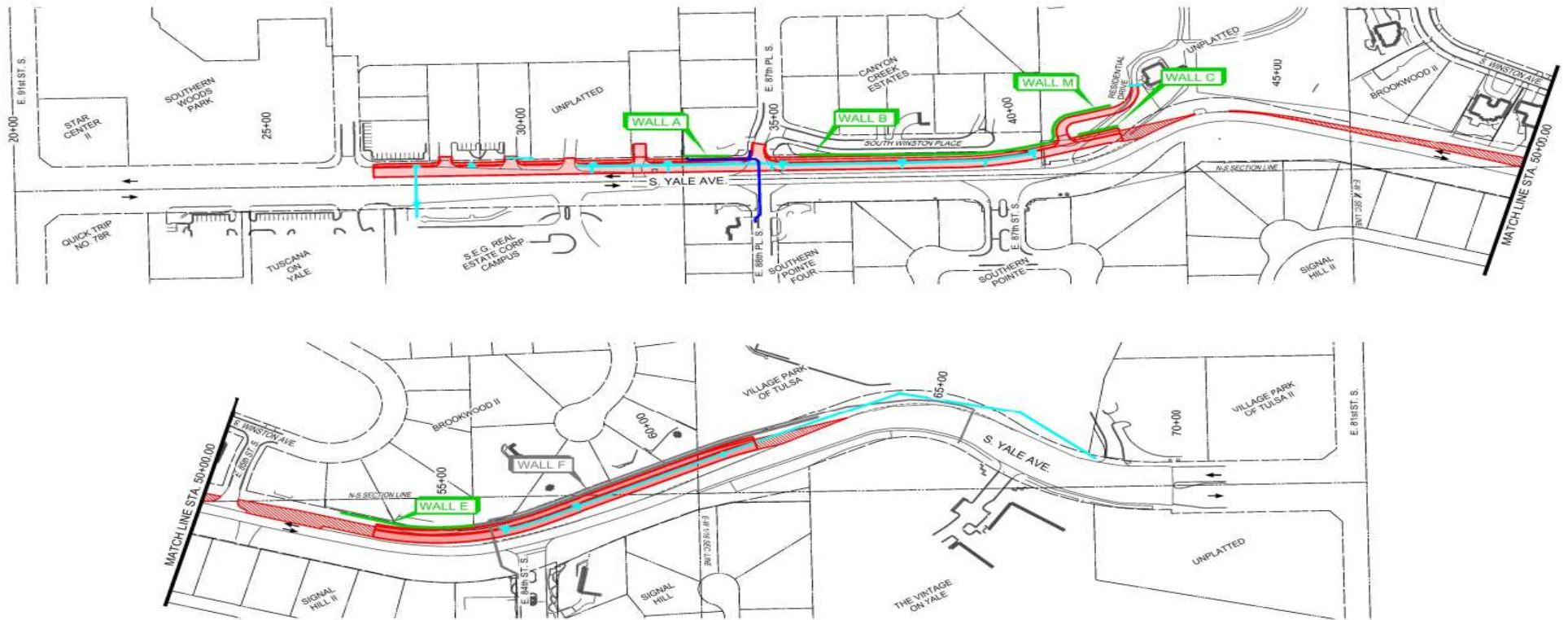

**PHASE 2**

# YALE AVE. WIDENING – 81<sup>ST</sup> TO 91<sup>ST</sup>

## CONSTRUCTION PHASING

### - PHASE 3 –

**IMPORTANT NOTE:** DATES PROVIDED IN THIS PRESENTATION ARE BASED ON THE BASELINE SCHEDULE AND ARE, THUS, SUBJECT TO CHANGE IF UNFORESEEN CONDITIONS ARISE DURING CONSTRUCTION.

- **START:** MAY-2022
- **END:** FEB-2023
- **DURATION:** APPROXIMATELY 10 MONTHS
- **TRAFFIC:** TWO-WAY TRAFFIC IN SOUTHBOUND LANES
- **ROADWAY:** NORTHBOUND PERMANENT PAVEMENT (S.E.G.; SOUTHERN POINTE; SIGNAL HILL; VINTAGE); RAISED MEDIANS
- **RETAINING WALLS:** 'G' (SOUTH OF 88<sup>TH</sup> PL); 'H' (SOUTHERN POINTE); 'J' (SIGNAL HILL – 84<sup>TH</sup> TO 87<sup>TH</sup>); 'K' (SIGNAL HILL – 84<sup>TH</sup> TO VINTAGE DRIVEWAY); 'L' (NORTH OF VINTAGE DRIVEWAY); 'N' (SIGNAL HILL AT 87<sup>TH</sup>)
- **WATERLINE:** 'A' (16" MAIN ALONG EAST SIDE OF YALE); 'G' (LATERAL TO SOUTHERN POINTE AT 87<sup>TH</sup>); 'H' (LATERAL TO BROOKWOOD AT NEW 85<sup>TH</sup>); 'J' (LATERAL TO SIGNAL HILL AT 84<sup>TH</sup>); 'K' (LATERAL TO VILLAGE PARK); 'L' (LATERAL TO VINTAGE); ~~'M' (TEMP LINE TO SIGNAL HILL AT 84<sup>TH</sup>)~~
- **STORM SEWER:** SOUTH SLOPE MAIN & LATERALS; NORTH SLOPE MAIN & LATERALS
- **SANITARY SEWER:** SIGNAL HILL AT 84<sup>TH</sup>

# YALE AVE. WIDENING – 81<sup>ST</sup> TO 91<sup>ST</sup>

## CONSTRUCTION PHASING

### - PHASE 3 -

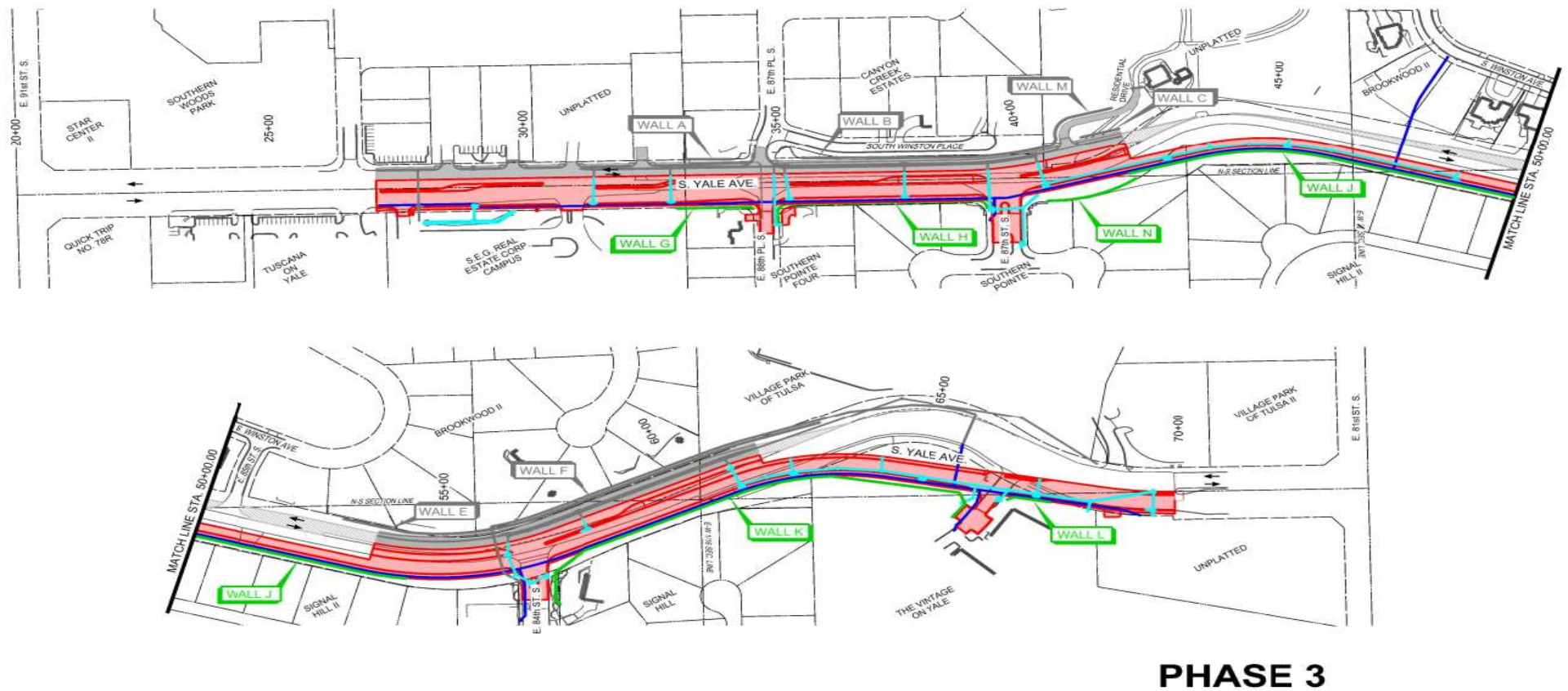



# YALE AVE. WIDENING – 81<sup>ST</sup> TO 91<sup>ST</sup>

## CONSTRUCTION PHASING

### - PHASE 4 –

**IMPORTANT NOTE:** DATES PROVIDED IN THIS PRESENTATION ARE BASED ON THE BASELINE SCHEDULE AND ARE, THUS, SUBJECT TO CHANGE IF UNFORESEEN CONDITIONS ARISE DURING CONSTRUCTION.

- **START:** FEB-2023
- **END:** AUG-2023
- **DURATION:** APPROXIMATELY 7 MONTHS
- **TRAFFIC:** TWO-WAY TRAFFIC IN **NORTHBOUND** LANES
- **ROADWAY:** SOUTHBOUND PERMANENT PAVEMENT (BALANCE); NEW 85<sup>TH</sup> ST. ENTRANCE TO BROOKWOOD; RAISED MEDIANS & LANDSCAPING
- **RETAINING WALLS:** 'C' (CATE PROPERTY – NORTH  $\frac{3}{4}$ ); 'D' (BROOKWOOD)
- **WATERLINE:** N/A
- **STORM SEWER:** MEDIAN LATERALS
- **SANITARY SEWER:** N/A

# YALE AVE. WIDENING – 81<sup>ST</sup> TO 91<sup>ST</sup> CONSTRUCTION PHASING

- PHASE 4 -

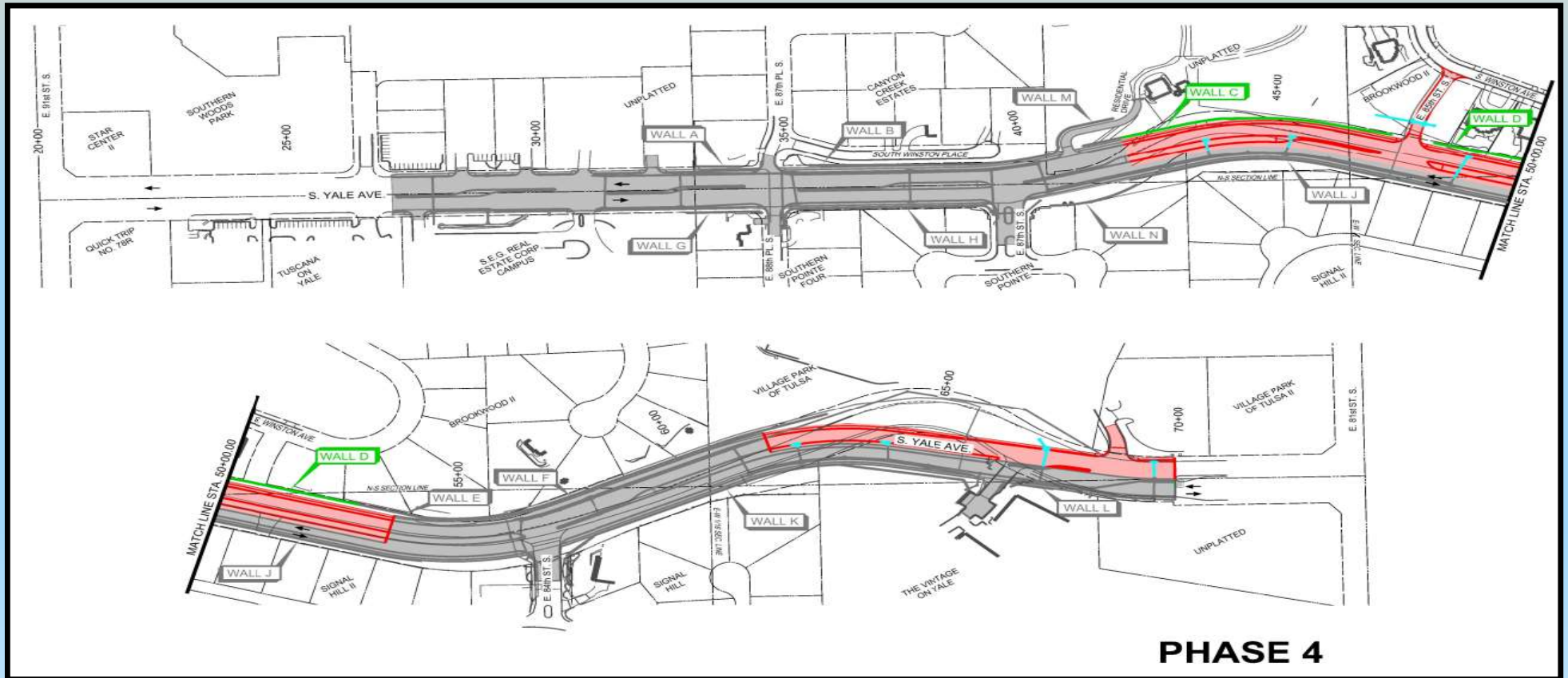

# YALE AVE. WIDENING – 81<sup>ST</sup> TO 91<sup>ST</sup> CONSTRUCTION PHASING

- PHASE 4 -

## LANDSCAPING – OVERALL PLAN

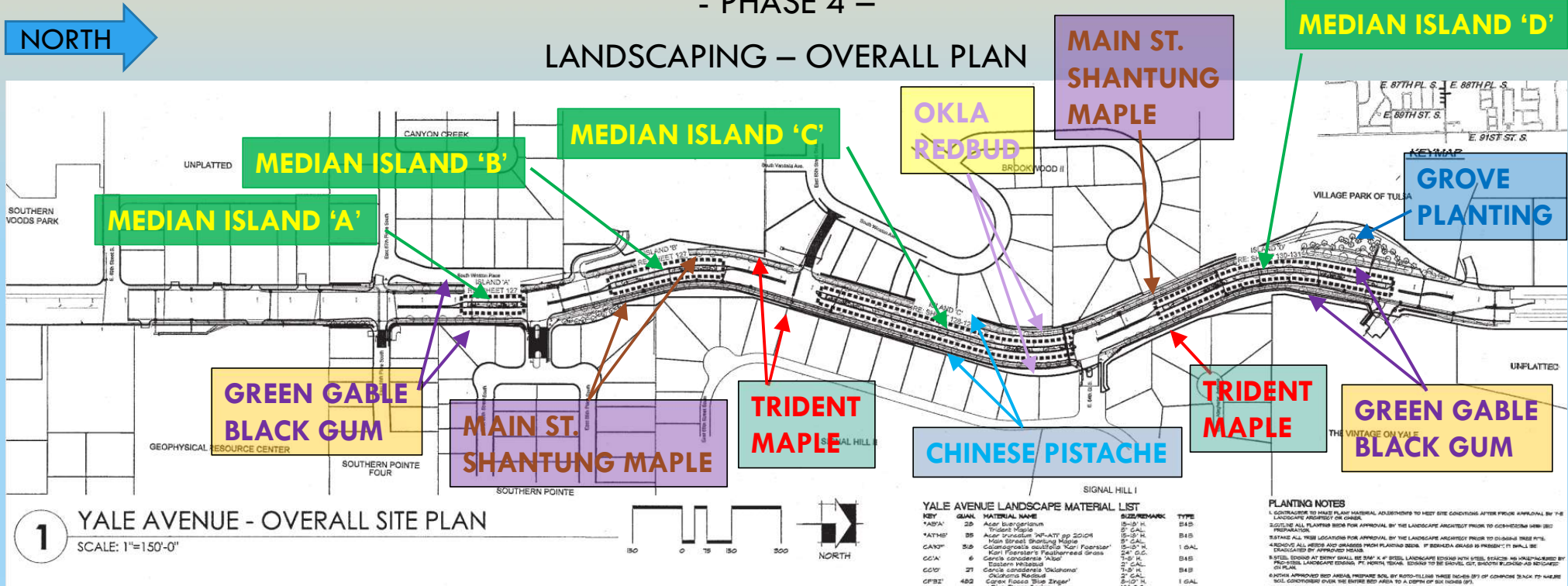

### GROVE PLANTING:

- \*FRONT: 8 OKLAHOMA REDBUDS; 5 EASTERN WHITEBUDS
- \*BACK: 22 LOBLOLLY PINES

# YALE AVE. WIDENING – 81<sup>ST</sup> TO 91<sup>ST</sup>

## CONSTRUCTION PHASING

- PHASE 4 -

### LANDSCAPING – TREE PLANTINGS



- GREEN GABLE  
BLACK GUM



- MAIN STREET  
SHANTUNG MAPLE



- TRIDENT MAPLE



- CHINESE PISTACHE



# YALE AVE. WIDENING – 81<sup>ST</sup> TO 91<sup>ST</sup>

## CONSTRUCTION PHASING

- PHASE 4 -

### LANDSCAPING – TREE PLANTINGS



- BALD CYPRESS



- OKLAHOMA  
REDBUD



- EASTERN  
WHITEBUD



- LOBLOLLY PINE



# YALE AVE. WIDENING – 81<sup>ST</sup> TO 91<sup>ST</sup>

## CONSTRUCTION PHASING

- PHASE 4 -

### LANDSCAPING – MEDIAN SHRUB PLANTINGS



- RED YUCCA



- COASTAL MUHLY  
GRASS



- “ANTHONY  
WATERER” SPIREA

# YALE AVE. WIDENING – 81<sup>ST</sup> TO 91<sup>ST</sup>

## CONSTRUCTION PHASING

- PHASE 4 -

### LANDSCAPING – MEDIAN SHRUB PLANTINGS



- KARL FOERSTER  
FEATHER REED GRASS



- PURPLE EXPLOSION  
LILYTURF (LIRIOPE)



- BLUE ZINGER  
SEDE



# YALE AVE. WIDENING – 81<sup>ST</sup> TO 91<sup>ST</sup>

## CONSTRUCTION PHASING

- PHASE 4 -

### LANDSCAPING – MEDIAN SHRUB PLANTINGS



- PRAIRIE  
DROPS EED



- WALKER'S LOW  
CATMINT



- LITTLE SPIRE  
RUSSIAN SAGE

- AND MANY MORE.....

# YALE AVE. WIDENING – 81<sup>ST</sup> TO 91<sup>ST</sup>

## QUESTION & ANSWER SESSION

- **QUESTIONS?**

- FEEL FREE TO INSERT QUESTIONS & COMMENTS IN THE CHAT.
  - FORMAT: [NAME]: QUESTION/COMMENT.

# YALE AVE. WIDENING – 81<sup>ST</sup> TO 91<sup>ST</sup>

## CLOSE OF MEETING

- **THANK YOU FOR JOINING US!**
- **CONSTRUCTION CONTACTS:**
  - **INSPECTOR:** STEVE MEDINA (HNTB)
    - **PHONE:** (918)-886-3525
    - **EMAIL:** SMEDINA@HNTB.COM
  - **SUPERINTENDENT:** ALVIN ATKINSON (BECCO)
    - **PHONE:** (918)-445-2684
    - **EMAIL:** ATKINSON@BECCOUSA.COM