

Purchasing/Public Works Bids

Version 3.1 released on 7/1/25



WSO/2/958

CITY COUNCIL USE ONLY

Date Received: _____
 Committee Date: _____
 1st Agenda Date: _____

Tracking #: _____
 Committee: _____
 Hearing Date: _____
 2nd Agenda Date: _____

CITY CLERK USE ONLY

Scanned Date: _____
 Posted Item #: _____

All department items requiring Council approval must be submitted through the Mayor's Office.

Primary Details

Board Approval

Tulsa Metropolitan Utility Authority

Other Board Name

City Council Approval

Yes No

PGSSC / SSA Approval

Contract #.
139361

Department

Water and Sewer

Contact Name

Kelsi Teel

Email

Contractadmin@cityoftulsa.org

Phone

918-596-9406

Bid/Project Number

ES 2024-17

Project Title

Citywide Lift Station Improvements Cherokee Park Lift Station

Bid Record Type

Award of Bid

Addendum

1

Bid Opening

Commodity Code

Vendor Name

Walters-Morgan Construction, Inc.

Vendor Number

669

Requesting Dept.

Requesting Dept. Contact

Budget

Funding Source(s)

2331S00012.SewerLines.Sewer.7500N.75003308-541101:	\$1,515,518.42
2531S00012.SewerLines.Sewer.7500.75003305-541101:	\$260,647.58
TOTAL:	\$1,776,166.00

Approvals

Department: _____

Legal: _____

Board: _____

Mayor: _____

Other: _____

Date: 5.1.2026

Date: _____

Date: _____

Date: _____

Date: _____

Policy Statement

Background Information

Submitted is the Tabulation of Bids and Recommendation of Award for Project No. ES 2024-17 Citywide Lift Station Improvements Cherokee Park Lift Station. Bids were received April 24, 2026. The Engineers Estimate prepared by HUB Engineering for Base Bid Plus Additive Alternate No. 1 for \$1,641,686.00. Three (3) bids were received ranging from \$1,776,166.00 to \$1,854,886.00 for Base Bid plus Additive Alternate No. 1. Walters-Morgan Construction, Inc. submitted the lowest bid for \$1,776,166.00 for Base Bid plus Additive Alternate No. 1. Construction duration 365 days.

Summation of the Requested Action

Recommended approval of award.

Other Pertinent Details

Signature
TGP/ATL/HAS/JR

Processing Information for City Clerk's Office

Post Execution Processing

- Mail vendor copy (add'l signature copies attached)
- Must be filed with other governmental entity
- Add'l governmental entity approval(s) required

Additional Routing and Processing Details

818 East Side Boulevard
Post Office Box 1543
Muskogee, OK 74402
P: (918) 682-7811
F: (918) 682-4551



2001 N Willow Avenue
Broken Arrow, OK 74012
P: (918) 251-0717
F: (918) 251-0754
hubengineers.com

ENGINEERS

April 28, 2026

Sergio Valles, E.I.
Tulsa Metropolitan Utility Authority
175 E 2nd Street, Suite 1300
Tulsa, OK 74107

Re: Citywide Lift Station Improvements
Cherokee Park Lift Station
Project No. ES 2024-17

Dear Mr. Valles,

We have tabulated the bids received on April 24, 2026, for the above referenced project. A copy of the tabulation is attached.

The Engineer's Estimate for the Total Base Bid Plus Additive Alternate No. 1 (Basis of Award) is \$1,641,686.00. Three bids were received for the project ranging from \$1,776,166.00 to \$1,854,886.00. Walters-Morgan Construction, Inc. was the apparent low bidder in the amount of \$1,776,166.00. Based on the bid results and available budget we recommend award of the Base Bid Plus Additive Alternate No. 1 in the total amount of \$1,776,166.00.

To the best of our knowledge Walters-Morgan Construction, Inc. is capable of performing the work as specified and should be considered for award of the project.

Sincerely,

HOLLOWAY, UPDIKE AND BELLEN, INC.



Stephen Tolar, P.E., S.E.
President

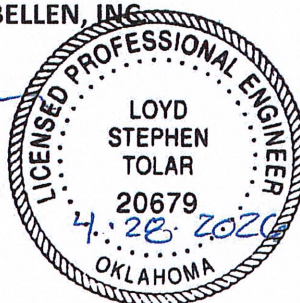

BID TABULATION

TULSA METROPOLITAN UTILITY AUTHORITY
 BIDS OPEN: APRIL 24, 2026
 CITYWIDE LIFT STATION IMPROVEMENTS - CHEROKEE PARK LIFT STATION
 TMUA PROJECT NO. ES 2024-17

ITEM NO. BASE BID	SPEC NO.	ITEM	QUANTITY	UNIT	ENGINEERS ESTIMATE		WALTERS-MORGAN CONSTRUCTION, INC.		DARIS CONTRACTORS, LLC.		CROSSLAND HEAVY CONTRACTORS, INC.	
					UNIT PRICE	AMOUNT	UNIT PRICE	AMOUNT	UNIT PRICE	AMOUNT	UNIT PRICE	AMOUNT
1	220	SWPPP	1	EA	\$5,000.00	\$5,000.00	\$2,000.00	\$2,000.00	\$4,200.00	\$4,200.00	\$2,800.00	\$2,800.00
2	221(C)	TEMPORARY SILT FENCE	638	LF	\$4.00	\$2,552.00	\$2.00	\$1,276.00	\$5.00	\$3,190.00	\$4.50	\$2,871.00
3	230(A)	SOLID SLAB SODDING	25	SY	\$12.00	\$300.00	\$64.00	\$1,600.00	\$6.00	\$150.00	\$55.00	\$1,375.00
4	303(A)	AGGREGATE BASE PARKING SURFACE	166	CY	\$105.00	\$17,430.00	\$135.00	\$22,410.00	\$200.00	\$33,200.00	\$285.00	\$47,310.00
5	334	CONTRACTOR AS-BUILT	1	EA	\$4,000.00	\$4,000.00	\$2,000.00	\$2,000.00	\$3,100.00	\$3,100.00	\$500.00	\$500.00
6	335	CONTRACTOR QUALITY CONTROL	1	LS	\$3,000.00	\$3,000.00	\$1,000.00	\$1,000.00	\$12,000.00	\$12,000.00	\$500.00	\$500.00
7	414(A)	P.C. CONCRETE PAVEMENT (PLACEMENT)	73	SY	\$250.00	\$18,250.00	\$160.00	\$11,680.00	\$220.00	\$16,060.00	\$90.00	\$6,570.00
8	641	MOBILIZATION	1	EA	\$50,000.00	\$50,000.00	\$65,000.00	\$65,000.00	\$72,400.00	\$72,400.00	\$45,000.00	\$45,000.00
9	642	CONSTRUCTION STAKING	1	EA	\$5,000.00	\$5,000.00	\$5,000.00	\$5,000.00	\$4,820.00	\$4,820.00	\$3,300.00	\$3,300.00
10	ODOT 602	CONCRETE SIDEWALK	48	SY	\$105.00	\$5,040.00	\$150.00	\$7,200.00	\$148.00	\$7,104.00	\$170.00	\$8,160.00
11	-	CHEROKEE LIFT STATION IMPROVEMENTS	1	EA	\$1,077,714.00	\$1,077,714.00	\$1,294,000.00	\$1,294,000.00	\$1,291,000.00	\$1,291,000.00	\$1,368,500.00	\$1,368,500.00
12	SP1.1	OWNER'S ALLOWANCE	25,000	EA	\$1.00	\$25,000.00	\$1.00	\$25,000.00	\$1.00	\$25,000.00	\$1.00	\$25,000.00
TOTAL BASE BID (BASIS OF AWARD)						\$1,213,286.00		\$1,438,166.00		\$1,472,224.00		\$1,511,886.00
ADDITIVE ALTERNATE NO. 1												
13	-	PUMP #4 AND APPURTENANCES, COMPLETE	1	EA	\$428,400.00	\$428,400.00	\$338,000.00	\$338,000.00	\$347,600.00	\$347,600.00	\$343,000.00	\$343,000.00
TOTAL ADDITIVE ALTERNATE NO. 1						\$428,400.00		\$338,000.00		\$347,600.00		\$343,000.00
TOTAL BASE BID PLUS ADDITIVE ALTERNATE NO. 1						\$1,641,686.00		\$1,776,166.00		\$1,819,824.00		\$1,854,886.00

APPROVED
 TULSA METROPOLITAN UTILITY AUTHORITY

I, Stephen Tolar, P.E., S.E., do hereby certify the above Bid Tabulations correctly reflects each bid received for the above referenced project.

Signature Date 4-28-2026

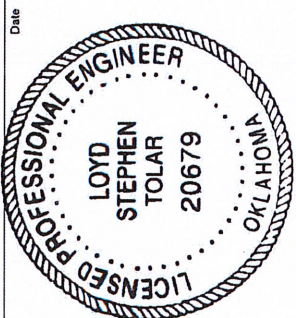

Design Manager, Water and Sewer

Signature Date 4/30/2026

PROJECT	PHASE	TASK	SUB-TASK	DEFAULT GL ORG	DEFAULT GL OBJ	2026 REVISED BUDGET	2026 ACTUAL (MEMO)	2026 ENCUMBRANCES	2026 INCEPTION TO SOY	2026 AVAILABLE	2026 PERCENT USED
2331S00012	SewerLines	Sewer	7500N	75003308	541101	2,760,576.57	344,069.14	866,030.02	34,958.99	1,515,518.42	45.10
2531S00012	SewerLines	Sewer	7500	75003305	541101	2,084,523.95	200,176.11	22,579.09	22,303.96	1,839,464.79	11.76

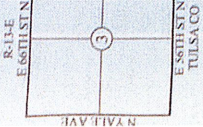

CONSTRUCTION PLANS FOR CITYWIDE LIFT STATION IMPROVEMENTS CHEROKEE PARK LIFT STATION

PROJECT NO. TMUA ES 2024-17

WATER AND SEWER DEPARTMENT CITY OF TULSA, OKLAHOMA

CHEROKEE PARK LIFT STATION

PLANS PREPARED BY
Holloway, Updike and Bellen, Inc.
Muskegon - Broken Arrow, Oklahoma
2001 N. WILLOW AVE. BROKEN ARROW, OK 74012
918-251-0717, FAX 918-251-0754
(C.A. No. 219, EXP. 6-30-27)

Brown Engineers of Arkansas, LLC
17200 CHENAL PKWY, STE 300 PNB 324
LITTLE ROCK, AR 72223
501-448-0100, FAX 866-846-4197
(C.A. No. 4533, EXP. 6-30-26)



EMERGENCY: 811
OF TULSA STANDARD SPECIFICATIONS AND STANDARD DETAILS GOVERN. INSTRUCTION AND MATERIALS SHALL BE IN ACCORDANCE WITH THE DEPARTMENT OF TRANSPORTATION 2019 OKLAHOMA STANDARD SPECIFICATIONS FOR HIGHWAY CONSTRUCTION. THESE PLANS COMPLY WITH ALL OKLAHOMA DEPARTMENT OF ENVIRONMENTAL QUALITY REQUIREMENTS.
THIS IS WITHIN THE CORPORATE LIMITS OF CITY OF TULSA (COT).

CONTACT		OFFICE
Tony Glenn	918-596-9245	
Emergency	888-216-3523	
Emergency	800-664-5463	
Emergency	800-288-2020	
Customer Service	918-806-6000	
Customer Service	888-294-6804	
Customer Service	800-347-1991	
Customer Service	918-830-0024	

COORDINATION INFORMATION		NEEDING SERVICES DEPARTMENT
DESIGN	918-596-6980	
DESIGN	918-596-6564	
DESIGN	918-596-6016	
DESIGN	918-596-6741	
DESIGN	918-596-6498	

UTM STATE PLANE COORDINATE (NAD 1983)

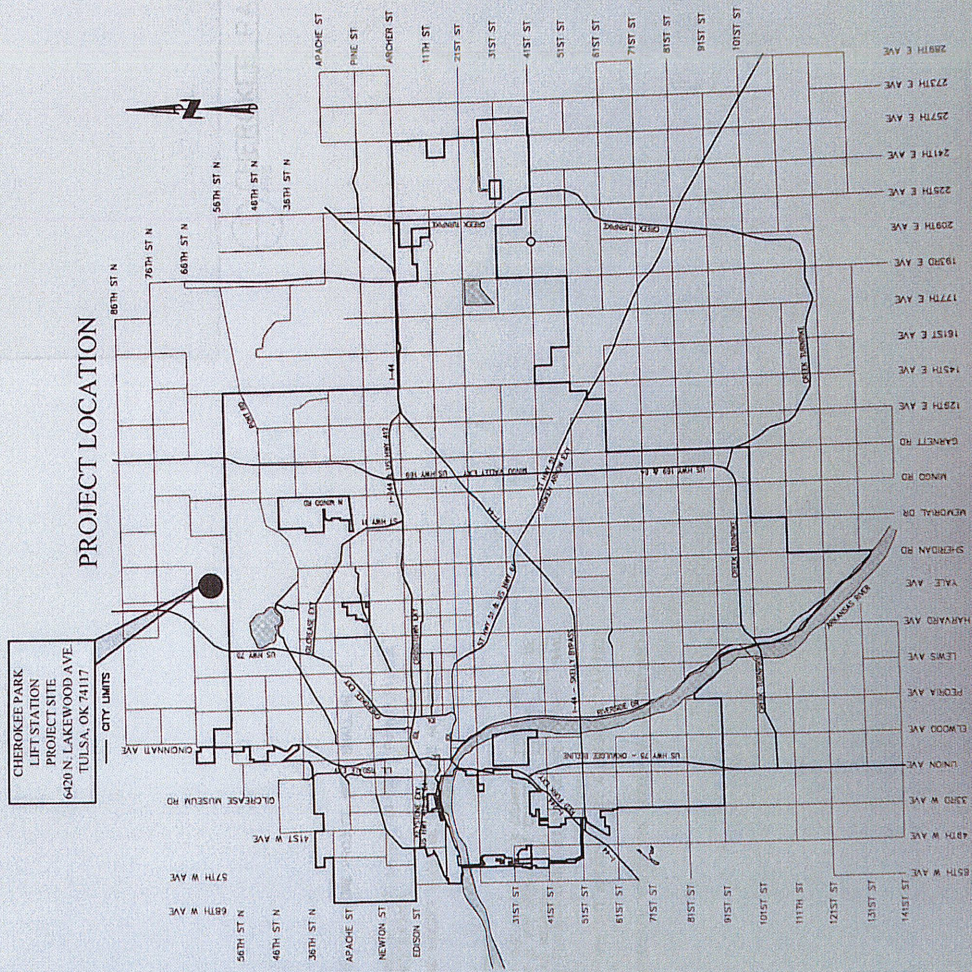

INDEX TO DRAWINGS

SHEET NO.	DESCRIPTION
1	COVER SHEET
2	LOCATION MAP & QUANTITIES SUMMARY
3	GENERAL NOTES
4	SYMBOLS & LEGEND
5	SURVEY DATA
6	STORMWATER MANAGEMENT PLAN
7	EROSION CONTROL PLAN
8	DEMOLITION PLAN
9	SITE IMPROVEMENTS PLAN
10	PAVING & GRADING IMPROVEMENTS PLAN
11	LIFT STATION DEMOLITION PLAN
12	LIFT STATION FLOOR PLAN
13	LIFT STATION PIPING SECTION
14	LIFT STATION CONTROL BUILDING
15	CONTROL BUILDING LAYOUT
16	CONTROL BUILDING DETAILS
17	LIFT STATION SCHEDULES
18	MISCELLANEOUS DETAILS
19-20	SECURITY FENCE DETAILS
21	ELECTRICAL LEGEND
E1	ELECTRICAL SITE PLAN
E2	ELECTRICAL LIFT STATION PLAN
E3	ELECTRICAL CONTROL BUILDING PLAN
E4	CONTROL BUILDING LIGHTING PLAN
E5	SCHEMATIC I
E6	ONE-LINE DIAGRAM
E7	ELECTRICAL SCHEDULES I
E8	ELECTRICAL SCADA
E9	VFD CABLE GROUNDING
E10	MECHANICAL NOTES & LEGEND
M1	CONTROL BUILDING HVAC PLAN & SCHEDULES
M2	MECHANICAL DETAILS
M3	

CITY OF TULSA STANDARD DETAIL

STD 715	PAVEMENT REMOVAL & REPLACEMENT
STD 730	STD. DEBRIS PORTLAND CEMENT CONCRETE
STD 730	STD. ASPHALT PAVEMENT CUT AND REPAIR



APPROVED BY

[Signature]

WATER AND SEWER DIRECTOR

DATE
3-2-2024



STEPHEN TOLAR, P.E., S.E.

HOLLOWAY, UPDIKE & BELLEN, INC.

DATE