

# Spring 2021

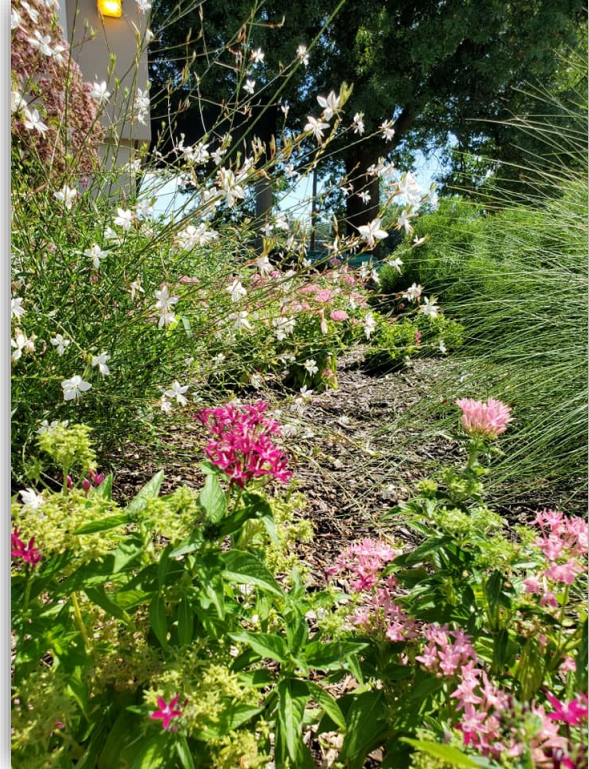

## WHITESIDE PARK & COMMUNITY CENTER



[WWW.TULSAPARKS.ORG](http://WWW.TULSAPARKS.ORG)

TULSA  PARKS

WHITESIDE RECREATION CENTER  
4009 S. PITTSBURG AVE.  
TULSA, OK 74135

Look inside for  
FUN WINTER  
ACTIVITIES!

## GENERAL INFORMATION

### STAFF

Sarah Gund.....Park Manager | [sgund@cityoftulsa.org](mailto:sgund@cityoftulsa.org)  
Luke McCollom.....Recreation Coordinator | [lmccollom@cityoftulsa.org](mailto:lmccollom@cityoftulsa.org)  
Tony Martin.....Recreation Coordinator | [raonmartin@cityoftulsa.org](mailto:raonmartin@cityoftulsa.org)  
Omare Jimmerson...Recreation Program Manager | [ojimmerson@cityoftulsa.org](mailto:ojimmerson@cityoftulsa.org)  
Anna America.....Park & Recreation Director | [annaamerica@cityoftulsa.org](mailto:annaamerica@cityoftulsa.org)

### Building Hours\*:

Monday.....8:30 a.m.–7:00 p.m.  
Tuesday.....8:30 a.m.–8:00 p.m.  
Wednesday.....8:30 a.m.–7:00 p.m.  
Thursday.....8:30 a.m.–8:00 p.m.  
Friday.....8:30 a.m.–5:00 p.m.  
Saturday.....9 a.m.–1 p.m. \*  
\*2nd and 4th Saturday each month

### Whiteside is Closed:

Friday, April 2.....Good Friday  
Monday, May 31....Memorial Day

***\*Hours are subject to change based on health and safety assessments in response to the COVID-19 pandemic.***  
***\*\* Building will close after the last scheduled activity.***

### COVID-19 Protocols

The City of Tulsa's Park and Recreation Department remains committed to ensuring the safety of our staff and residents, and continues to consult with the Tulsa Health Department and CDC guidelines.

Please note the following temporary practices and protocols are in place at our center:

- Building hours and programs are subject to change in response to health guidance and protocols, including additional restrictions, rescheduling and/or cancellations.
- Online registration is available at [www.tulsaparks.org](http://www.tulsaparks.org) and is the preferred method of enrollment and payment for all programs and events to reduce your wait time and increase safety.
- Masks are required for anyone to enter the facility and temperature and contact information will be taken.
- Each program will have a unique set of health and safety guidelines for the activity/event.

Additional updates and policies will be communicated by center staff as well as posted online to our website and social media accounts.

## THINGS TO KNOW

**We are located in Midtown Tulsa on East 41st Street, off South Pittsburg Avenue, which is north of I-44 between Harvard and Yale, and across the street from Patrick Henry Elementary School.**

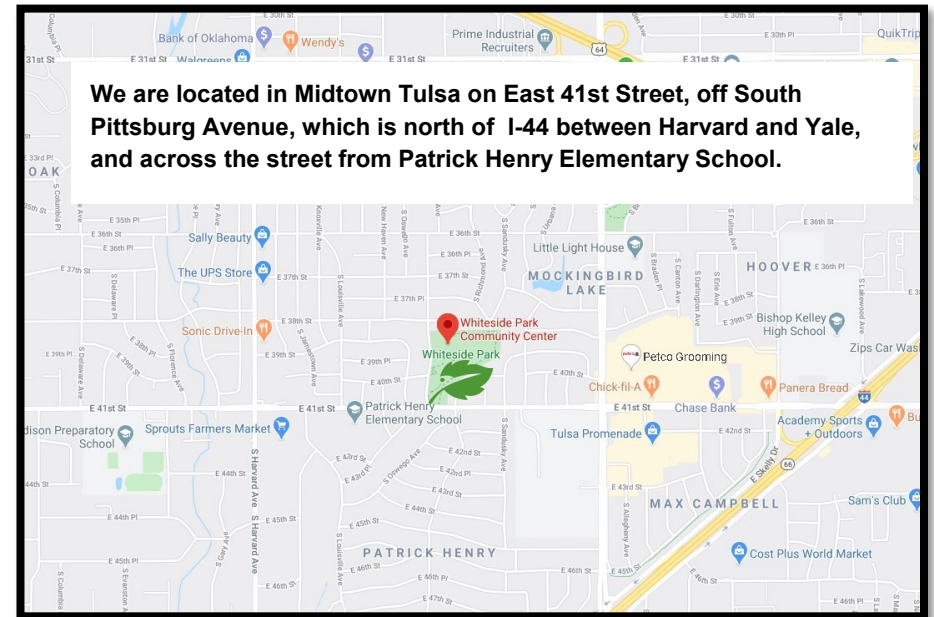

### Contact Information:

For shelter rentals, call: 311 | For Whiteside programs, call: (918) 596-1525

**Get updates about events, classes, closings and more on our Facebook pages:**  
[@WhitesideParkTulsa](https://www.facebook.com/WhitesideParkTulsa) | [@TulsaParks](https://www.facebook.com/TulsaParks)

### CLASS ENROLLMENTS

Please make a point to pre-enroll in any programs you are interested in attending. Programs not meeting minimum enrollment prior to the start date, will be cancelled. Enroll online at [www.tulsaparks.org](http://www.tulsaparks.org) or in person at Whiteside Community Center!

### NON-RESIDENT FEE (NRF)

Please note: a 25% additional fee will be assessed for non-residents of the City of Tulsa in all rental and programming fees.

### ID CARDS

Persons over the age of 10 must obtain a FREE Tulsa Parks ID card to participate in activities at the community center. Please make the front desk your first stop!

### NEW IDEAS

Have you got a new idea for a class or special event? Do you have talent you want to share with others by facilitating a class? Shoot us an e-mail or give us a call!

## PICKLEBALL

### PICKLEBALL LEAGUE

Adults ages 30 and over can join our adult Pickleball League. Beginners and intermediate will play at Whiteside. Round Robin league structure.

**Resident:** \$20 per player

**Non –resident:** \$25 per player

Play begins Tuesday, April 13. For more information contact [lmccollom@cityoftulsa.org](mailto:lmccollom@cityoftulsa.org).



### OPEN PICKLEBALL PLAY

A great game for fun, socialization and exercise! Ask to be put on our Pickleball e-mail list for monthly calendars, schedule updates, etc.

**Reservations by appointment only\* Call for available slots within the following schedule: Must be 18+ to play**

**Mondays, Wednesdays and Fridays:** 12:40-2:40 p.m.

**Tuesdays & Thursdays:** 9:00-11:00 a.m. | 12:40-2:40 p.m. | 5:30-7:30 p.m. (Thursdays only)

**\*Saturdays:** 9:00 a.m.-1:00 p.m. | (check schedule for available Saturday play).

*\*Reserving a time does not mean that you or your "group" has exclusive use of the court. Please make sure you are including the people waiting in the rotation.*

### **Health and safety guidelines for pickleball after checking in:**

- Mask must be worn at all times.
- Wash and sanitize hands frequently.
- Bring own supplies (We will supply balls).
- Wipe down equipment before and after each use.
- Maintain 6 ft physical distancing at all times.
- 12 players allowed in gym at one time.
- Reserve your spot and time ahead of time, no walk-ins if gym is full.

## Adult Classes

### **MORNING ZUMBA w/ SARAH**

Start your day off right by joining us for a one-hour class of active dancing that's sure to be as fun as it is calorie-burning!

**Drop-In Class:** \$6 | **Residents:** \$30/8 classes | **Non-residents:** \$37/8 classes

**Mondays and Fridays at 9 a.m.**

### OVER-40 BASKETBALL

Open basketball courts and games for adults over 40.\* | **FREE**

**Mondays, Wednesdays and Fridays:** 11:30 a.m.-12:30 p.m..

*\* Until restrictions are lifted, we are limiting this program to practice type drills or individuals. Limited number of slots per day.*

## ADULT CLUBS

### PORTRAIT PAINTERS

For experienced artists ages 18 and older who want to paint portraits with a live model. Must bring your own painting supplies | Participants split cost for model.

**Tuesdays:** 11 a.m. | *Please check with Whiteside or Facebook prior to coming, as groups have been doing virtual and outdoor sessions due to COVID-19.*





## TENNIS

Whiteside has a great tennis program for both kids and adults. Our coaches are experienced, patient and eager to help beginners learn the game while also working with more experienced players to gain stamina, agility and strength.

### LESSONS WITH COACH KEITH: Adult Classes (18+)

Level 1 for adults 18+ is designed for the beginner player. Level 2 is designed for adults 18+ that already play and need a more advanced learning/playing session. Lessons start the week of March 22.

**Mondays and Wednesdays: 12 lessons**

**Level 2: 6:00p.m.-7:30p.m.**

**Tuesdays and Thursdays: 12 lessons**

**Level 1: 6:00p.m.-7:30p.m.**

No classes the following dates: April 12th, 14th and 26th.

**\$85 for residents | \$106 for non-residents**

### LESSONS WITH COACH ROBERTA: Youth Classes

Coach Roberta is looking forward to coaching your child, whether beginner or advanced.

**Tuesdays and Thursdays: 4wks**

**Session 1: March 23rd-April 15th**

**Session 2: April 20th-May 13th**

**Level 1: 4:00p.m. Ages 6-8**

**Level 2: 5:00p.m. Ages 9-14**

**\$50 for residents | \$62 for non-residents**



## KIDS' SPRING DAY CAMPS

Registration for Kids' Spring Day Camps begins February 15 and this year, Whiteside is offering 2 spring break camps.

Camp hours are 9 a.m. to 4 p.m. Children may be dropped off as early as 7:30 a.m. and picked up as late as 5:30 p.m. at no extra cost. Each camper will need to bring their own non-refrigerated lunch, eating utensils and water bottle each day unless otherwise instructed. We have exciting weeks full of games and activities planned, so sign up early as these camps usually fill up quickly!

Full payment is required at registration. If you can register and pay for your children online, that is preferred, but you will still need to come into the center to complete additional paperwork. Please bring a copy of their shot record and a small photo at that time. There is a \$10 sibling discount when enrolling multiple children from the same family.

CAMP COSTS PER CHILD	
<b>Spring Break:</b> March 15-19	<b>Residents:</b> \$140   <b>Non-Residents:</b> \$175
<b>Easter Break:</b> April 5-9	<b>Residents:</b> \$140   <b>Non-Residents:</b> \$175

### COVID-19 DAY CAMP PROTOCOLS

- Enrollment will be limited to 20 participants so that small groups can be maintained during camp activities.
- Temperatures will be taken each day upon arrival at camp.
- Drop-off and pick-up will be outside at the door. Staff will be present to sign your child in and out.
- Masks will be required for all staff and campers at all times while in the building. There will be times when masks may be removed, including when playing outside, lunch and snack time.
- Separate craft supplies will be provided for each child.
- Physical distancing will be practiced to the best of our ability.
- Field trips are planned, but may be canceled based on health restrictions that may be in effect at the time of camp.



## Adult Classes

### SUMMER BREAK CAMP (AGES 6-12):

Our summer day camps are filled with sports, games, arts and crafts, special events and field trips. Tulsa Zoo, Oxley Nature Center, Gathering Place and Lubell Park are just a few of the places we will visit. We go where the fun is! All trips as well as a camp t-shirt are included in the camp fees. Our camps are also accredited with the American Camping Association.

- Camp sessions run weekly Monday-Friday, 9 a.m.-5 p.m., starting June 14 through August 13.
- Extended hours are offered at no extra cost. Children may be dropped off as early as 7:30 a.m. and picked up no later than 5:30 p.m.
- Children will need to bring their own non-refrigerated lunch daily unless otherwise instructed.

### COST & ENROLLMENT:

- \$140 per week for Tulsa residents and \$175 per week for non-residents
- Day camps are also available at Hicks Park, Jane A. Malone Center in Chamberlain Park, Lacy Park, Reed Park, Central Center in Centennial Park and WaterWorks Art Center. Prices vary at each location.
- Full payment is required at registration for the first session of camp in which your child is enrolled. We accept cash, check, VISA and MasterCard as forms of payment.
- A non-refundable/non-transferable deposit of \$25 per session reserves your child's spot in any additional sessions
- Multi-child discounts are available for children in the same family household.
- Discounts are available to current City of Tulsa employees.
- In-person enrollment begins Saturday, April 10 at 9 a.m.
- Online enrollment opens Tuesday, April 13. Full payment of all sessions is due upon registration when enrolling online.



TULSA  PARKS

**WHITESIDE PARK  
PRESENTS**

# 2021 SPEED CLINIC

**SPONSORED BY  
TITAN SPORTS & PERFORMANCE CENTER**

**WITH SPECIAL GUEST MIGUEL WICKERT  
DIRECTOR OF SPORTS PERFORMANCE AT TITAN**

**MIGUEL@TITANSPORTSCOMPLEX.COM**

**COME WORK ON**

- ACCELERATION
- CHANGE OF DIRECTION
- MAX VELOCITY

**SATURDAY MARCH 27th  
10AM-11:30AM  
WHITESIDE PARK  
LIMITED SPACES  
AVAILABLE**

**SIGNUP AT:  
CITYOFTULSA.ORG  
OR CALL 918-596-1525  
4009 S. PITTSBURG AVE  
TULSA, OK**

**REGISTRATION DEADLINE:  
3/20/2021**



## BIRTHDAY PARTIES

### MESSY ARTIST OR LIL SCIENTIST BIRTHDAY PARTY(AGES 3-6)

Kids can enjoy messy art projects or fun science experiments while parents enjoy NOT cleaning up the mess afterwards! This party package includes an hour of activities and an hour for cake and gifts. Parents are responsible for bringing all food and drinks as well as table/room decorations.

**Residents:** \$135 | **Non-Residents:** \$168 | 10 child maximum

**Saturdays:** 10 a.m. to Noon | By appointment only



### BIKES & BALLS BIRTHDAY PARTY (AGES 2-6)

We will set up slides, child-sized basketball hoops, and more so kids can play to their little hearts' delight! Parents are responsible for bringing all food and drinks as well as table/room decorations.

**Residents:** \$130 | **Non-Residents:** \$162 | 15 child maximum

**Saturdays:** 10 a.m. to Noon | By appointment only

### BUILD IT PARTY (AGES 3-6)

If your child likes to build with blocks, toy bricks, boxes and more, we've got the perfect birthday party for them! An hour with some building fun led by an instructor and an hour in a party room for cake and gifts. Parents are responsible for bringing all food and drinks as well as table/room decorations.

**Residents:** \$130 | **Non-Residents:** \$162 | 10 child maximum

**Saturdays:** 10 a.m. to Noon | By appointment only

### GYMNASTICS PARTIES (AGES 4-11)

Kids enjoy an hour with a gymnastic coach and an hour in the party room. All parents must sign a waiver before children can participate. Parents are responsible for bringing all food and drinks as well as table/room decorations.



**Residents:** \$130 | **Non-Residents:** \$162 | 10 child maximum

**Saturdays:** 10 a.m. to Noon | By appointment only.

## RENTALS

Do you need a room to host a birthday party, baby shower or meeting? Wanting to teach a class but need a space? Whiteside has a variety of rooms and amenities that can help you host a great event!



The following rooms are available to rent. Premium hours are subject to staff availability.

**Please note:** due to COVID-19 restrictions large gatherings are not permitted at this time, as well as party sizes and available amenities may be limited.

ROOMS	STANDARD RATE RESIDENT	STANDARD RATE NR	PREMIUM RATE RESIDENT	PREMIUM RATE NR
FULL GYM	\$50	\$63	\$80	\$93
HALF OF GYM	\$25	\$31	\$55	\$61
MULTI-PURPOSE ROOMS	\$30	\$38	\$60	\$68

## SERVICE GROUPS

Did you know that Scout troops and Camp Fire groups are able to host their meetings at Whiteside...**FREE OF CHARGE?!**

If you're a leader of a troop and need a place to meet with your troop on a weekly or monthly basis, please contact the Whiteside staff. We would be happy to help you find a convenient time and space for your group!







# PUNT PASS KICK

MAY  
22

**COME TEST YOUR SKILLS  
AT OUR FIST ANNUAL PUNT,  
PASS, KICK EVENT AT  
WHITESIDE PARK. FOOTBALL  
GAMES, SPEED CHALLANGES,  
PRIZES AND LOTS MORE!**

**REGISTRATION DEADLINE:  
MAY 15  
LIMITED SPACES AVAILABLE**

SIGNUP AT:  
CITYOFTULSA.ORG  
OR CALL 918-596-1525  
4009 S. PITTSBURG AVE  
TULSA, OK

TULSA  PARKS

**BOYS & GIRLS  
AGES  
6-15**

**WHITESIDE RECREATION CENTER PRESENTS**

## *Pup-a-palooza*

**Join us for an event hosted for pups and their families. Don't yet have a doggo? No worries! Several pet adoption organization will also be attending.**

### **PUPPY YOGA**

**12pm - 1pm**

**Adopt a dog or donate one of the items listed below for access to Puppy Yoga**

**SATURDAY APRIL 24, 2021**

**STARTING AT 10 A.M.**

**WHITESIDE PARK  
4009 S. PITTSBURG  
918-596-1527**



**This event is free to attend, but we will be accepting donations of pet food, pet supplies, pet bedding, etc. Please note: All dogs must be on a leash. Dogs in heat are not allowed.**

TULSA  PARKS



## YOUTH GYMNASTIC CLASSES

### TUESDAY CLASSES

**Session 1:** March 2-April 13 | **Session 2:** April 20-May 25

CLASS	TIME	AGE	INSTRUCTOR
KINDERPLUS	4:15-5 P.M.	3-5 YEARS	Coach Amber
JR. BEGINNER	5-5:55 P.M.	4-6 YEARS	Coach Amber
BEGINNER	6-6:55 P.M.	6-10 YEARS	Coach Amber
BEGINNER PLUS	7-7:55 P.M.	10-14 YEARS	Coach Amber
Parent Watch Days	TBA	All	No Class: March 16

### THURSDAY CLASSES

**Session 1:** March 4-April 15 | **Session 2:** April 22-May 27

CLASS	TIME	AGE	INSTRUCTOR
JR. BEGINNER	4-4:55 P.M.	4-6 YEARS	Coach Autumn
JR. BEGINNER	5-5:55 P.M.	4-6 YEARS	Coach Autumn
BEGINNER	6-6:55 P.M.	6-10 YEARS	Coach Autumn
Parent Watch Days	TBA	ALL	No Class: March 18

### FRIDAY CLASSES

**Session 1:** March 5-April 23 | **Session 2:** April 30-June 4

CLASS	TIME	AGE	INSTRUCTOR
KINDERPLUS	3:15-3:55 P.M.	3-5 YEARS	Coach Autumn
INTERMEDIATE	4-4:55 P.M.	7-14 YEARS	Coach Autumn
BEGINNER	5-5:55 P.M.	6-10 YEARS	Coach Autumn
Parent Watch Days	TBA	ALL	No Class: March 19 April 2

**Cost per 6-week session: \$70 for residents | \$85.00 for non-residents**

**Sibling Discount:** \$5 off the 2nd child enrolled from the same family

Payment is due in full when enrolling for Session 1. You may reserve your child's spot in Sessions 2 by placing a \$20 deposit, but **only if** they are currently enrolled in Session 1.

## YOUTH GYMNASTICS TEAM



### WHITESIDE TWISTERS COED GYMNASTICS TEAM

Girls and boys ages 5-16 from all over Green Country come to participate in this great program and compete in the Tulsa Parks Recreational League.

**Cost:** \$80 per month Additional fees for uniforms, meet fees and league fee.

Practice days are Mondays and Wednesdays

**Please note:** parents must contact Whiteside to set up a try-out period for their child before they can join this team.

## YOUTH DANCE CLASSES

### TINY DANCERS BALLET (AGES 3-7)

A 6-week introductory class to ballet for preschool through elementary school-age dancers. Children will need to bring their own ballet shoes.

**All ballet classes are held on Thursdays:**

**Session 1: March 25-April 29**

AGE	TIME	COST (R/NRF)
3-4	4-4:30 p.m.	\$50 / \$62
5-7	4:45-5:45 p.m.	\$60 / \$75

