

PUBLIC WORKS
Engineering

DATE:

November 24, 2025

**ADDENDUM NO. 1
TO
PROJECT NO. CDBG 25-001 Sidewalks (47th & Braden)**

This Addendum No. 1 consisting of four (4) items, submitted by City of Tulsa is hereby made a part of the Contract Documents to the same extent as though it were originally included therein and shall supersede anything contained in the Plans and Specifications with which it might conflict. **All addenda to the contract documents should be denoted on the last page of the Proposal in the space provided.**

This Addendum No. 1 consists of the following:

1. **Replace** the Notice to Bidder Pages (NTB1-NTB2) with the **attached Notice to Bidder Page (NTB1-NTB2)**.
2. **Remove** Resolution No. 18145 pages (R-1-R-3).
3. **Remove** 50% Resident Resolution Affidavit Page (RRA-1).
4. **Add** Drawings – Plan pages 1-3 and Standard Sidewalk Ramp.

All other provisions of the Plans and Specifications shall remain in full force and effect.

CITY OF TULSA

Paul D. Zachary, P.E.
Deputy Director

HAS/ML/JR/ma

1000 x 1000

TUL * USA

Published in the Tulsa World:
November 7, 10, 11, 12, 13, 14, 2025

**NOTICE TO BIDDERS
SEALED BIDS FOR
PROJECT NO. CDBG 25-001**

Notice is hereby given that pursuant to an order by the Mayor of the City of Tulsa, Oklahoma, sealed bids will be received in Room 260 of the Office of the City Clerk, City of Tulsa, 175 E. 2nd Street, Tulsa, Oklahoma 74103 until **8:30 a.m. the 12th day of December, 2025** for furnishing all tools, materials and labor and performing the work necessary to be done in the construction of the following:

**PROJECT NO. CDBG 25-001 SIDEWALKS
(47TH & BRADEN)**

The entire cost of the improvement shall be paid from Account No.

A **MANDATORY** Pre-Bid Conference is scheduled for **Tuesday, November 18, 2025 at 9:30 a.m.** and will be held through video conferencing with Microsoft Teams, invitation presented on the City of Tulsa's website at this link:

<https://www.cityoftulsa.org/government/departments/engineering-services/construction-bids/>

Attendance at the Pre-Bid Conference is MANDATORY. Bids will not be received from contractors who did not attend the Pre-Bid Conference.

Bids will be accepted by the City Clerk from the holders of valid pre-qualifications certificates from the City of Tulsa in one or more of the following classifications: **A or C.**

Drawings, specifications and contract documents for construction of said public improvements of the said project have been adopted by the Mayor of said City. Copies of same may be obtained at the Office of Contract Administration, 175 E. 2nd St., 13th Floor, Tulsa, OK 74103 for a non-refundable fee in the amount of **\$50.00** made payable to the City of Tulsa by check or money order.

Contract requirements shall include compliance as required by law pertaining to the practice of non-discrimination in employment.

Attention is called to Resolution 7404 of November 8, 2006, requiring bidders, their subcontractors and their lower-tier subcontractors to hire only citizens of the United States.

The City of Tulsa itself is exempt from the payment of any sales or use taxes, and pursuant to Title 68 O.S. Section 1356(10), direct vendors to the City are also exempt from those taxes. A bidder may exclude from his bid appropriate sales taxes, which he will not have to pay while acting for and on behalf of the City of Tulsa.

A Certified or Cashier's Check or Bidders Surety Bond, in the sum of 5% of the amount of the bid will be required from each bidder to be retained as liquidated damages in the event the successful bidder fails, neglects or refuses to enter into said contract for the construction of said public improvements for said project and furnish the necessary bonds within thirty days from and after the date the award is made.

The bidder to whom a contract is awarded will be required to furnish public liability and workmen's compensation insurance; Performance, Statutory, and Maintenance bonds acceptable to the City of Tulsa, in conformity with the requirements of the proposed contract documents. The Performance, Statutory, and Maintenance bonds shall be for one hundred percent (100%) of the contract price.

All bids will be opened and considered by the Bid Committee of said City at a meeting of said Committee to be held in the City Council Room of City Hall in said City at 9:00 a.m. on the 12th day of December, 2025.

Dated at Tulsa, Oklahoma, this 7th day of November, 2025.

(SEAL)

Christina Chappell
City Clerk

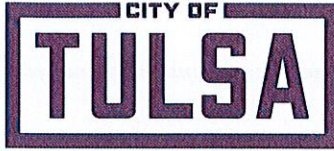

PUBLIC WORKS
Engineering

DATE:
November 18, 2025

TO:
Plan Holders
Contractors

FROM:
Jenna Richardson
918-596-9637
jennarichardson@cityoftulsa.org

EMAIL TRANSMITTAL

ADDENDUM NO. 1

PROJECT NO. CDBG 25-001 Sidewalks (47th & Braden)

Number of pages: 4

All addenda to the contract documents should be denoted on the last page of the Proposal in the space provided.

Thank you,
Contract Administration

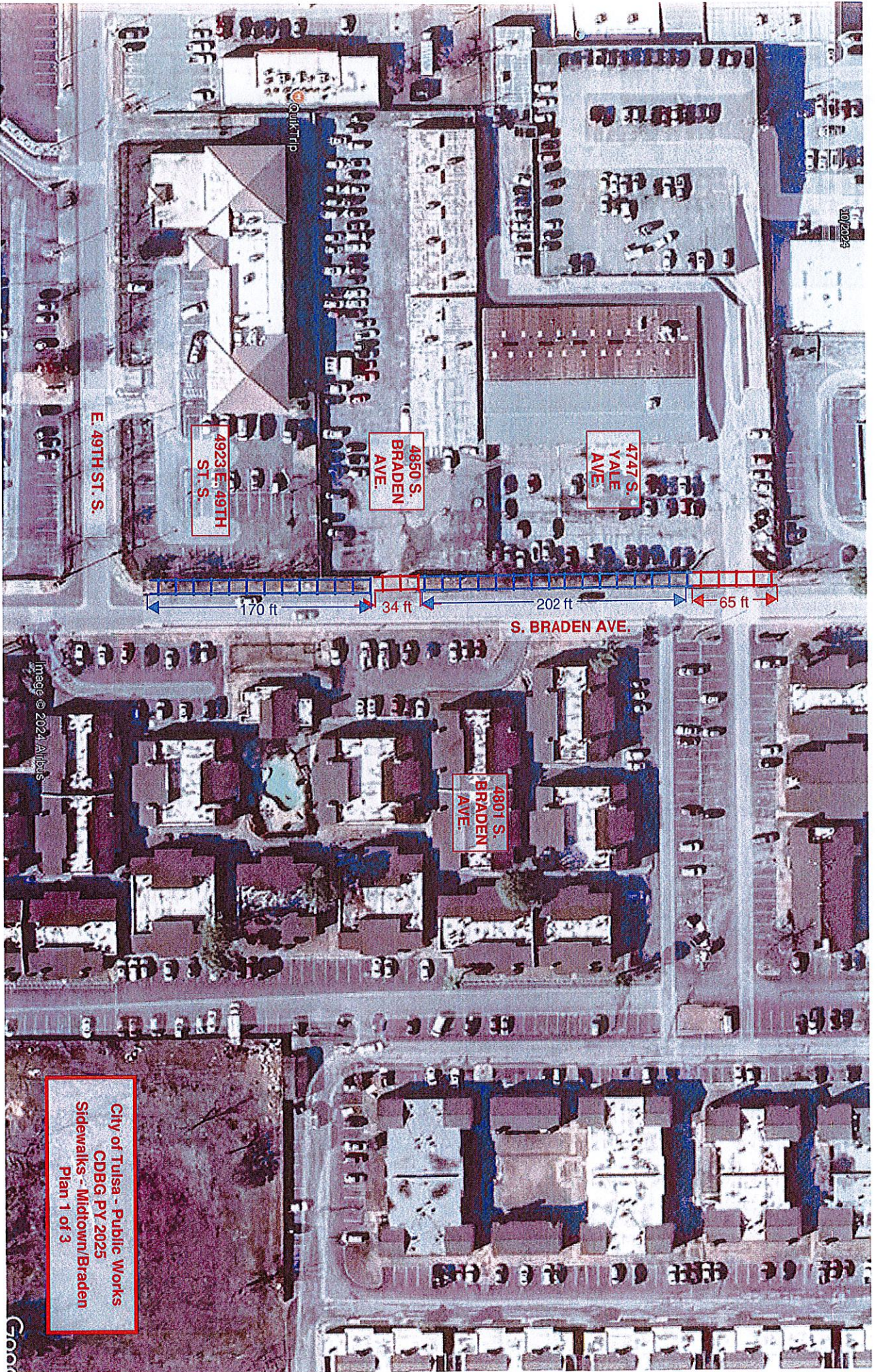

City of Tulsa - Public Works
CDBG PY 2025
Sidewalks - Midtown/Braden
Plan 1 of 3

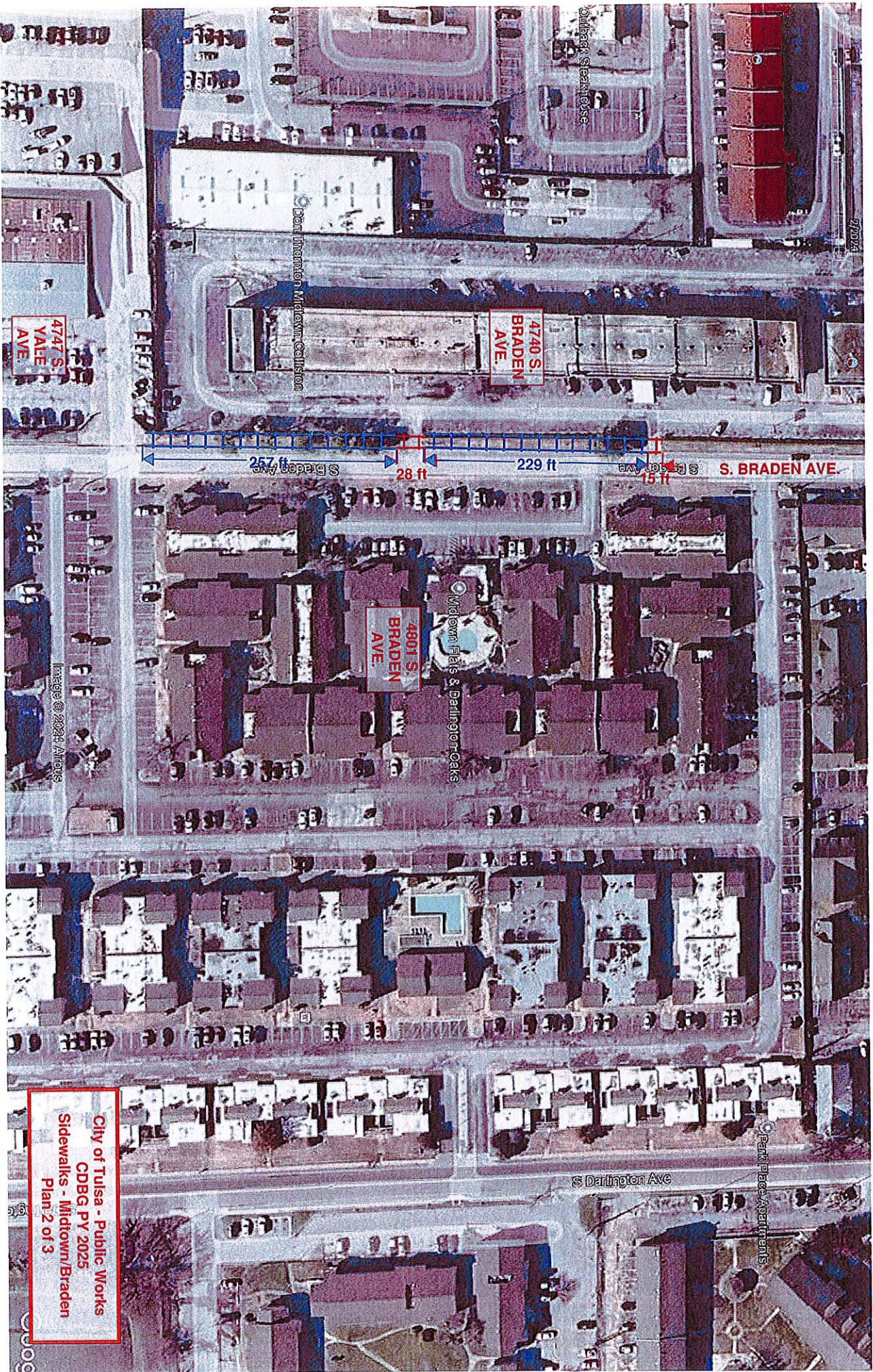

4747 S. VALE AVE.

4740 S. BRADEN AVE.

4801 S. BRADEN AVE.

S. BRADEN AVE.

S. Darlington Ave

City of Tulsa - Public Works
CDBG PY 2025
Sidewalks - Midtown/Braden
Plan 2 of 3

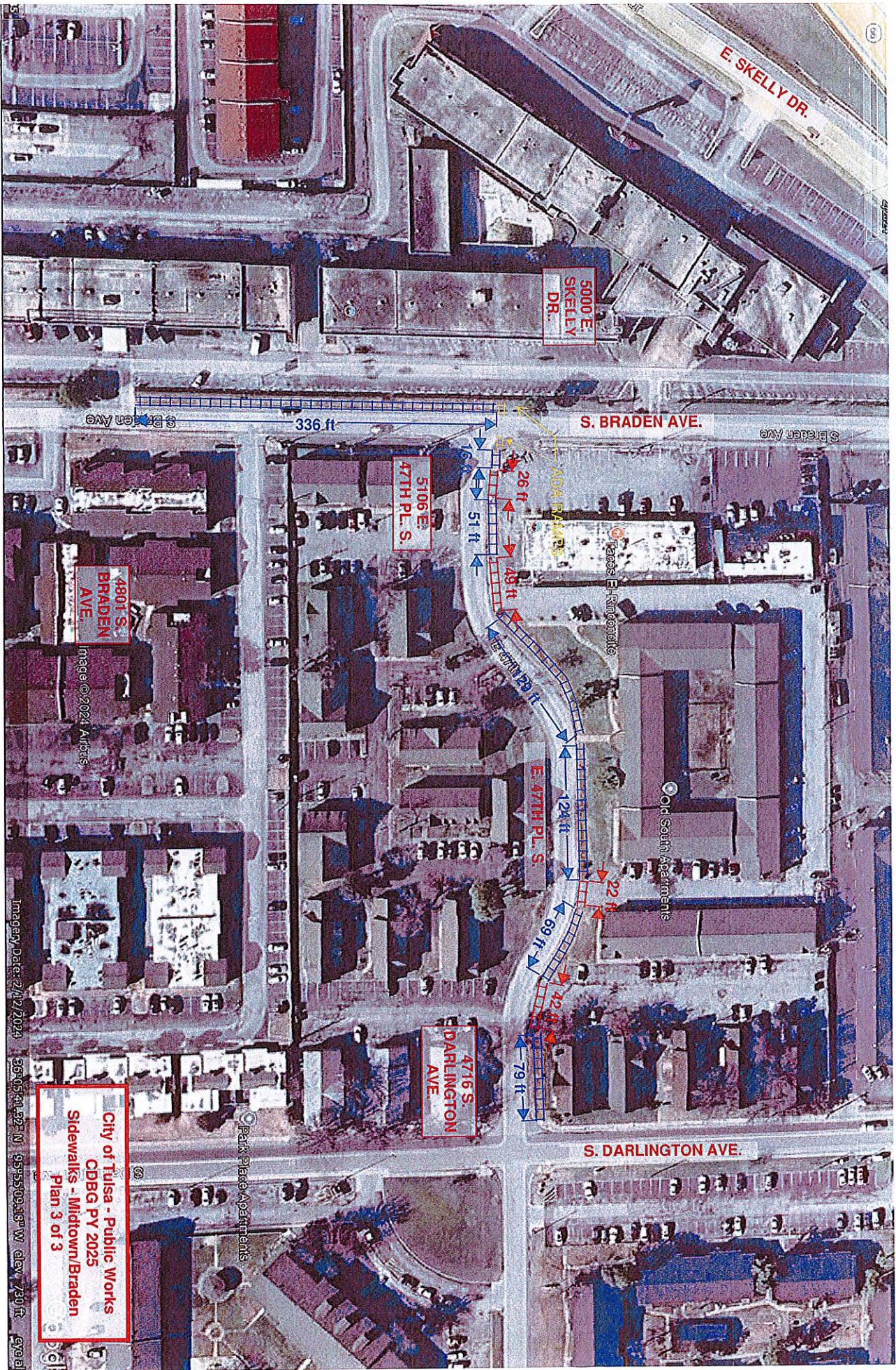

City of Tulsa - Public Works
CDBG PY 2025
Sidewalks - Midtown/Braden
Plan 3 of 3

Imagery Date: 2/12/2024

36°05'41.42" N 95°55'09.18" W elev. 730 ft. eye alt

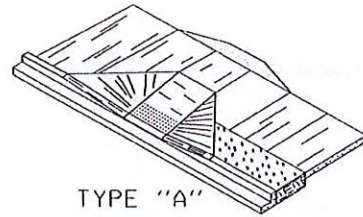

TYPE "A"

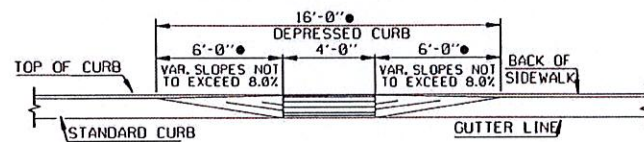
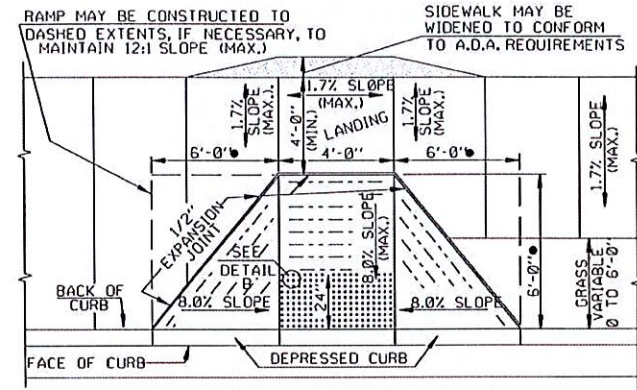

ELEVATION

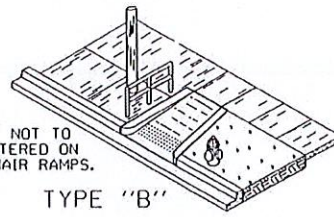

TYPE "B"

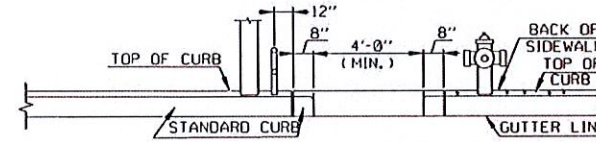
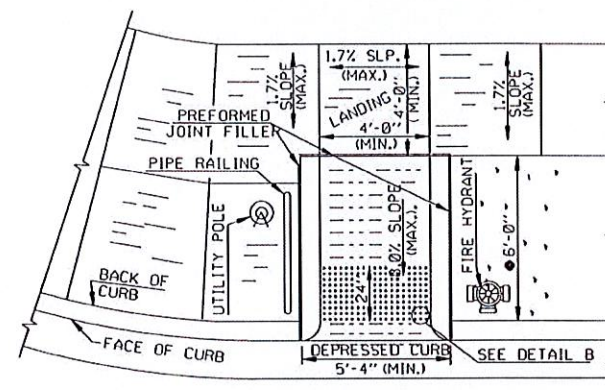

ELEVATION

▲ FOR MEDIAN GREATER THAN 15'-9"
USE TYPE "B" RAMP WITH MINIMUM 48"
LANDING - IF MEDIAN IS 15'-9" OR LESS
(5'-0" MIN.) SIDES ARE TO BE FORMED AS
SHOWN IN THE DETAIL BELOW.

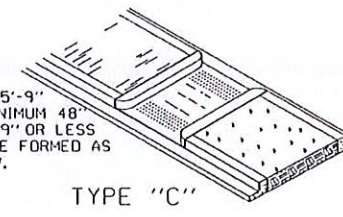

TYPE "C"

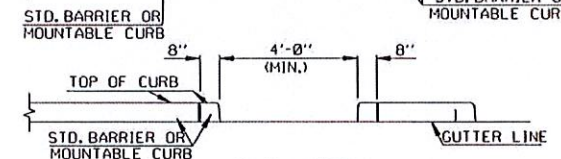
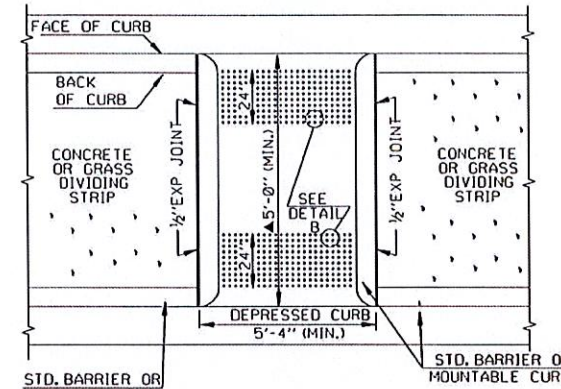

ELEVATION

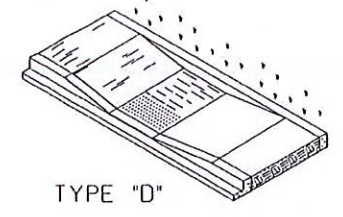

TYPE "D"

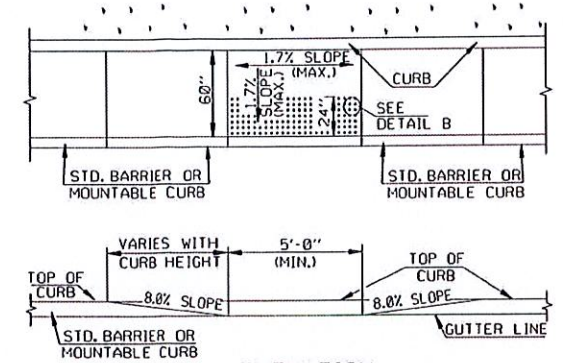

ELEVATION

GENERAL NOTES

- RAMP DIMENSIONS SHOWN ARE BASED ON A CURB HEIGHT OF SIX INCHES. THE DIMENSIONS SHOULD BE ADJUSTED FOR OTHER CURB HEIGHTS. THE MAXIMUM PERMISSIBLE SLOPES OF THE WHEELCHAIR RAMPS IS 8.33% (12:1). RAMP SLOPE MAY BE 10:1 (MAX.) ALONG FACE OF TAPERED CURB.
- TRANSVERSE GROOVING SHALL NOT BE USED ON RAMPS.
- DRAINAGE STRUCTURES SHALL NOT BE PLACED IN LINE WITH THE RAMPS.
- THE NORMAL GUTTER LINE PROFILE SHALL BE MAINTAINED THROUGH THE AREA OF THE RAMP WITH A 1.7% SLOPE (DESIGN MAX.). SEE NOTE NO. 10.
- WHEELCHAIR RAMPS SHOULD BE LOCATED SO THAT THE RAMP WILL BE ON THE TRAFFIC APPROACH SIDE OF ANY OBSTACLE.
- WHEELCHAIR RAMPS SHOULD BE BUILT AS SHOWN ON THE PLANS OR AS DIRECTED BY THE ENGINEER. THE TYPE OF RAMP WILL BE DESIGNATED ON THE PLANS. IF A RAMP IS TO BE CONSTRUCTED AS A COMBINATION OF TWO TYPES (ONE SIDE TYPE A AND ONE SIDE TYPE B), THE RAMP SHALL BE DESIGNATED AS TYPE A-B.
- PIPE RAILING CONSTRUCTION DETAILS, WHEN REQUIRED AT TYPE B WHEELCHAIR RAMPS, WILL BE SHOWN ON THE PLANS.
- EXCAVATION, BACKFILL, EXPANSION JOINT MATERIAL, PIPE RAILING, SEALERS, AND OTHER RELATED MISCELLANEOUS ITEMS WILL NOT BE PAID FOR SEPARATELY BUT THE COST THEREOF SHALL BE INCLUDED IN THE COST OF THE SIDEWALK RAMP.
- ALL FEATURES OF CONSTRUCTION INCLUDING, BUT NOT LIMITED TO, SIDEWALKS, CURB RAMPS, AND CROSSWALK MARKINGS SHALL COMPLY WITH THE PROPOSED RIGHTS-OF-WAY ACCESSIBILITY GUIDELINES (PROWAG), WHERE SPATIAL LIMITATIONS OR EXISTING FEATURES WITHIN THE LIMITS OF THE PROJECT PREVENT FULL COMPLIANCE WITH PROWAG, THE CONTRACTOR SHALL IMMEDIATELY NOTIFY THE ENGINEER UPON DISCOVERY OF SUCH FEATURE(S). THE CONTRACTOR SHALL NOT PROCEED WITH ANY ASPECT OF THE WORK WHICH IS NOT IN FULL COMPLIANCE WITH THE PROWAG WITHOUT PRIOR WRITTEN APPROVAL FROM THE ENGINEER. ANY WORK WHICH IS NOT PERFORMED WITHIN THE GUIDELINES OF THE PROWAG, FOR WHICH THE CONTRACTOR DOES NOT HAVE WRITTEN APPROVAL, SHALL BE COLLECTED AT THE CONTRACTOR'S EXPENSE.
- AGGREGATE BASE SHALL BE PAID FOR SEPARATELY AND ESTIMATED AT 2.4 C.Y. FOR EACH RAMP AT CORNER LOCATIONS.
- WHEELCHAIR RAMPS SHALL BE PAID FOR BY EACH.
- THE TRUNCATED DOMES WILL BE MEASURED AND PAID FOR BY THE SQUARE FOOT OF PANEL AREA. THE ROWS OF TRUNCATED DOMES SHALL ALIGN PERPENDICULAR OR RADIAL TO THE GRADE BREAK BETWEEN THE RAMP, LANDING OR BLENDED TRANSITION AND THE STREET.
- PIPE RAILING SHALL BE PAID FOR BY THE LINEAR FOOT.
- SIDEWALKS AND RAMPS SHALL MEET THE ADA ACCESSIBILITY TECHNICAL REQUIREMENTS AS SHOWN AT WWW.ACCESS-BOARD.GOV/PROWAG/

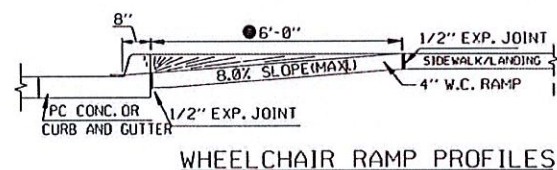

WHEELCHAIR RAMP PROFILES

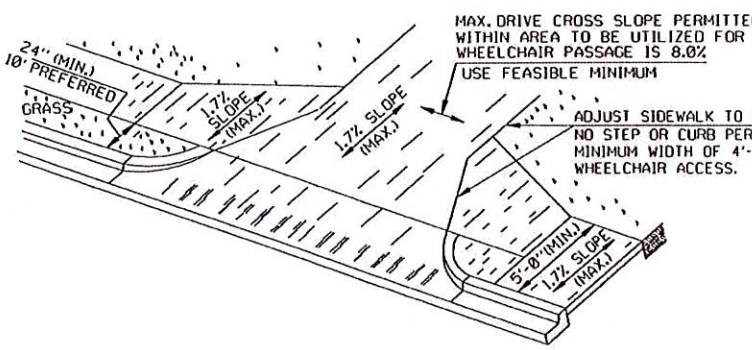

TACTILE WARNING DETAILS INSTALLATION NOTES

THE TRUNCATED DOME SURFACE SHALL CONTRAST VISUALLY WITH THE ADJOINING WALKING SURFACES.

THE TRUNCATED DOMES SHALL BE:
- PRE-CAST CONCRETE PANELS WITH A NOMINAL THICKNESS OF 7/8 INCH TO 2 INCHES, AND A MINIMUM SIZE OF 12" X 16". THEY SHALL BE CONSTRUCTED WITH A MINIMUM OF 4000 PSI CONCRETE. THEY SHALL BE YELLOW IN COLOR AND MEET ALL ADA REQUIREMENTS FOR COLOR CONTRAST AND DIMENSIONS
OR
- FLANGED CAST IN PLACE GLASS AND CARBON REINFORCED COMPOSITE PANEL AS MANUFACTURED BY ADA SOLUTIONS
OR
- DUCTILE IRON
OR
- CAST IRON

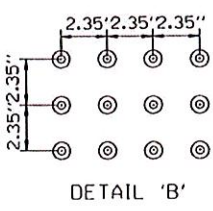
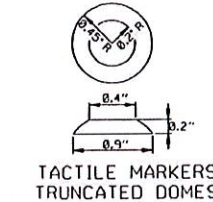

DETAIL 'B'

RETROFIT INSTALLATIONS WILL NOT REQUIRE EXISTING DEPRESSED CURBING TO BE REPLACED. A NOMINAL 6 TO 8 INCH SETBACK FROM FACE OF CURB SHALL BE ENFORCED FOR NEAR EDGE OF TACTILE DOMES.

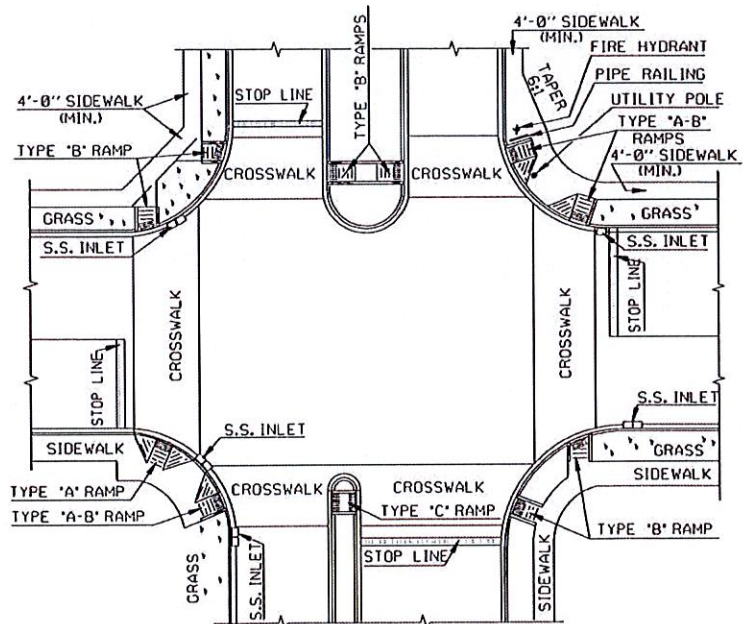

THE ABOVE EXAMPLES ARE TYPICAL ONLY AND ARE SHOWN TO ILLUSTRATE POSSIBLE RAMP TYPES, POSSIBLE RAMP LOCATIONS, POSSIBLE INLET LOCATIONS, AND HOW THE RAMP WILL BE DESIGNATED ON THE PLANS. CARE SHOULD BE EXERCISED TO ASSURE THAT MEDIAN RAMP AND CURB RAMP LINE UP, AND THAT RAMPS THROUGHOUT A PROJECT ARE LOCATED WITH SOME DEGREE OF UNIFORMITY. TYPE 'A' RAMPS SHOULD BE USED WHEREVER POSSIBLE.

■ THICKNESS OF RAMP AND ADJACENT SIDEWALK SHALL BE A MINIMUM OF 4" AT ARTERIAL INTERSECTIONS THE THICKNESS OF THE RAMP AND SIDEWALK ADJACENT TO THE CURB RADIUS SHALL BE 8".

REVISION	BY	DATE

[Signature]
CITY ENGINEER

[Signature]
DESIGN MANAGER

CITY OF TULSA, OKLAHOMA
ENGINEERING SERVICES DEPARTMENT

STANDARD SIDEWALK RAMP

DATE: MARCH 2021

STD. 790